

Kit 1430

NISSAN King Cab, 4-dr Pickup Double Cab, 05-*

NISSAN Navara, 4-dr Pickup Double Cab, 05-*

NISSAN Pathfinder, 5-dr SUV, 05-*

* Without roof railing

480R
754

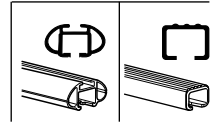
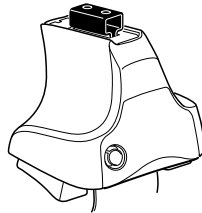

480

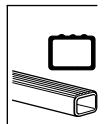
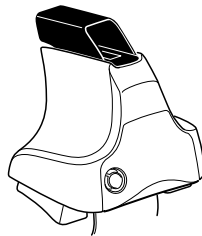

750

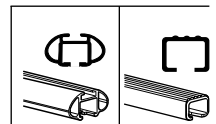
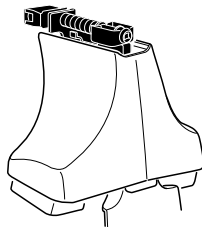

Kit

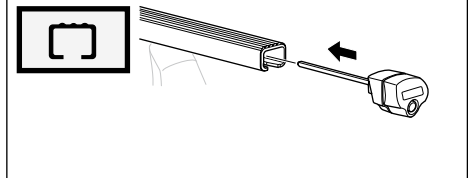
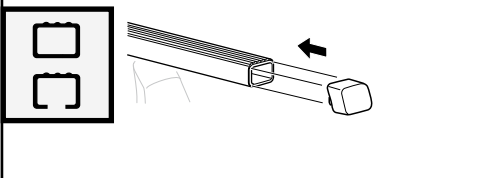
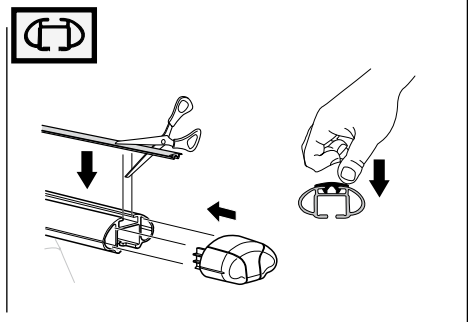
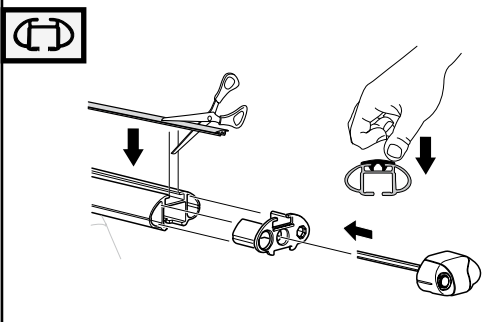
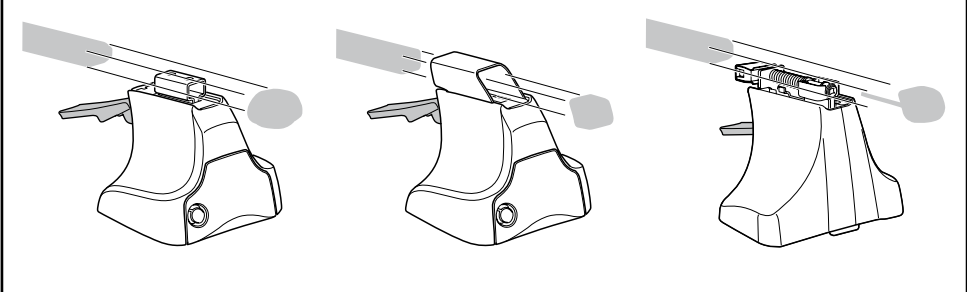
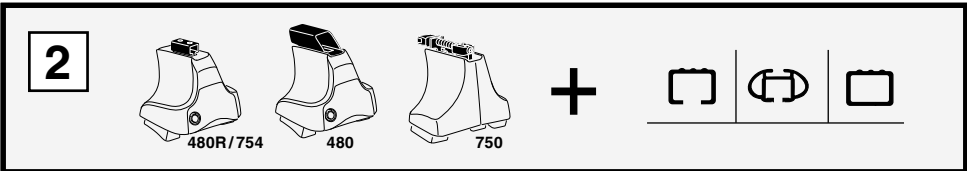
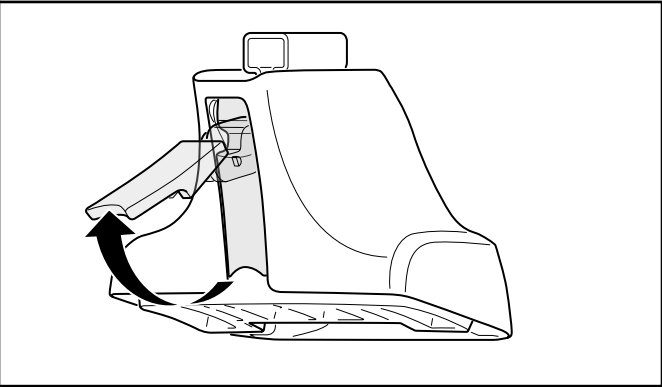
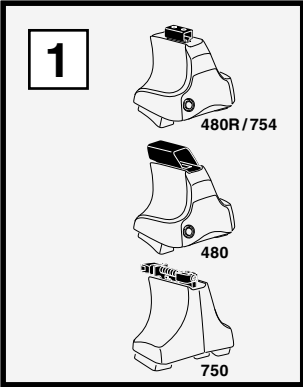

3

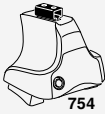

1

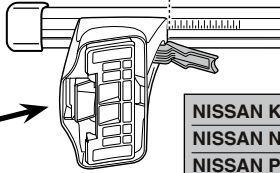
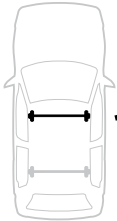

2

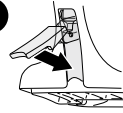

	X
NISSAN King Cab , 4-dr Pickup Double Cab, 05–	46,5
NISSAN Navara , 4-dr Pickup Double Cab, 05–	46,5
NISSAN Pathfinder , 5-dr SUV, 05–	46,5

1

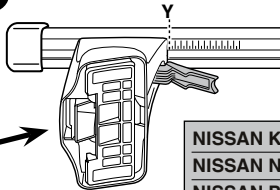

2

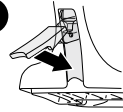

	Y
NISSAN King Cab , 4-dr Pickup Double Cab, 05–	45
NISSAN Navara , 4-dr Pickup Double Cab, 05–	45
NISSAN Pathfinder , 5-dr SUV, 05–	45



480R



480

1

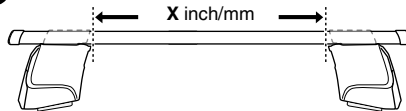
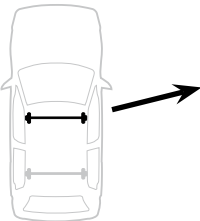

2

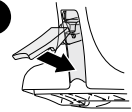

	X inch	X mm
NISSAN King Cab , 4-dr Pickup Double Cab, 05–	43 ⁷ / ₈ "	1116 mm
NISSAN Navara , 4-dr Pickup Double Cab, 05–	43 ⁷ / ₈ "	1116 mm
NISSAN Pathfinder , 5-dr SUV, 05–	43 ⁷ / ₈ "	1116 mm

1

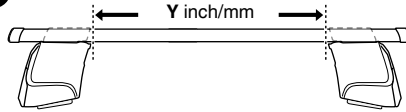
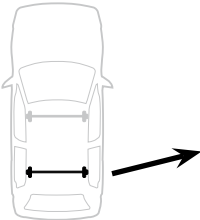

2

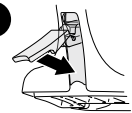

	Y inch	Y mm
NISSAN King Cab , 4-dr Pickup Double Cab, 05–	43 ³ / ₈ "	1101 mm
NISSAN Navara , 4-dr Pickup Double Cab, 05–	43 ³ / ₈ "	1101 mm
NISSAN Pathfinder , 5-dr SUV, 05–	43 ³ / ₈ "	1101 mm

4

NISSAN King Cab, 4-dr Pickup Double Cab, 05-
 NISSAN Navara, 4-dr Pickup Double Cab, 05-
 NISSAN Pathfinder, 5-dr SUV, 05-

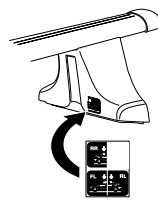
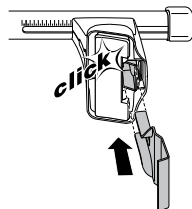
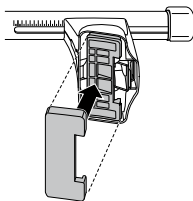
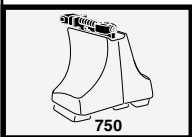
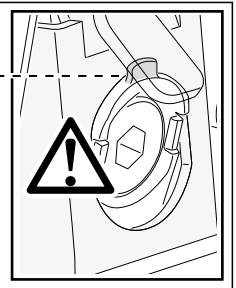
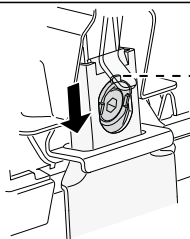
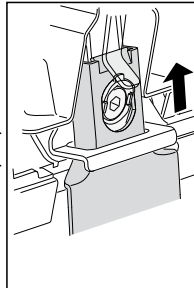
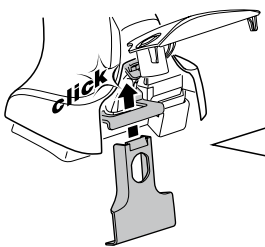
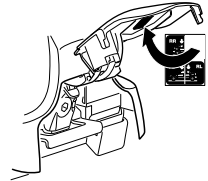
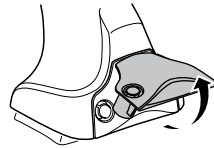
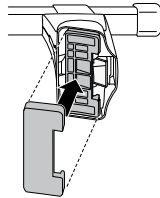
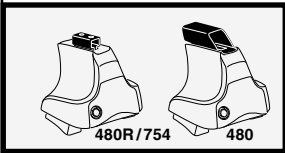
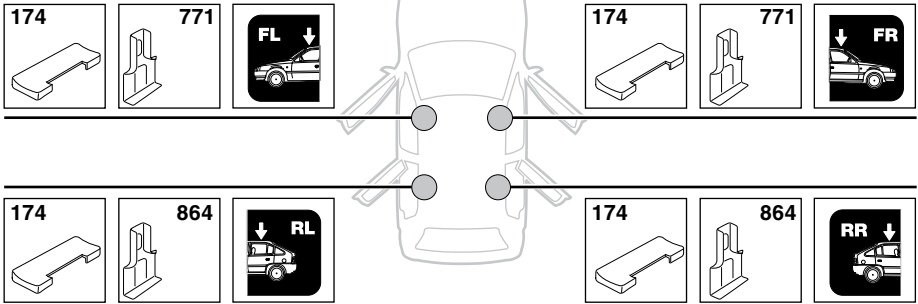

5



	X mm	Y mm	X inch	Y inch
NISSAN King Cab, 4-dr Pickup Double Cab, 05–	260 mm	750 mm	10 1/4"	29 1/2"
NISSAN Navara, 4-dr Pickup Double Cab, 05–	260 mm	750 mm	10 1/4"	29 1/2"
NISSAN Pathfinder, 5-dr SUV, 05–	260 mm	750 mm	10 1/4"	29 1/2"

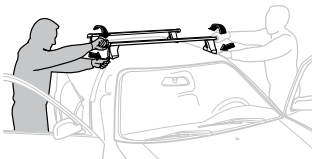
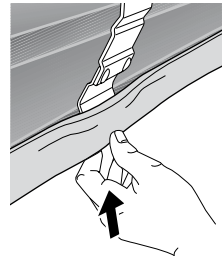
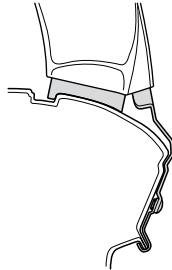
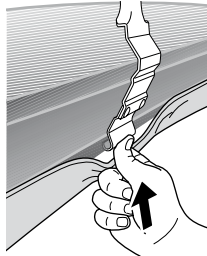
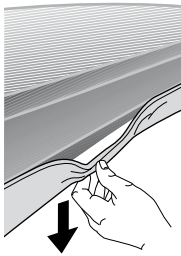
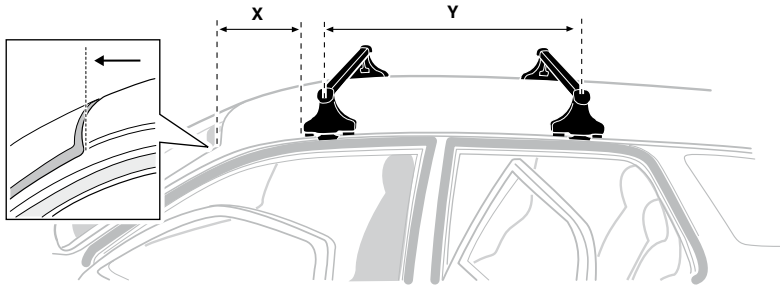

GB/US Tighten alternately
D Die Schrauben abwechselnd anziehen
F Serrer alternativement chaque côté
NL Afwisselend aan de linker- en de rechterkant aandraaien
I Alternare il serraggio delle viti
E Apretar alternativamente
PT Aperte alternadamente
S Dra åt växelvis
FIN Kierrä vuorotellen
EST Pinguldage vaheldumisi
LAT Pievelciēt pamišus
LIT Užsukinėkite pakaitomis
PL Śruby dokręcaj naprzemiennie
RU Затягивайте попеременно

CZ Pokrétla багажníka dokręcaj dokręcaj naprzemiennie.
SK Dofahujte striedavo
SLO Privijajte izmenično.
HR Naizmjenično zategniti
HU Egymásról függetlenül szorítandó
GR Σφιγγετε εναλλάξ
TR Dönüşümlü sıkın

中文 交替拧紧
한국어 번갈아 가며 조이십시오.
日本語 交互に締め付けてください。
ไทย ขันในแบบสลับ

6

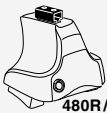

480R/754



480

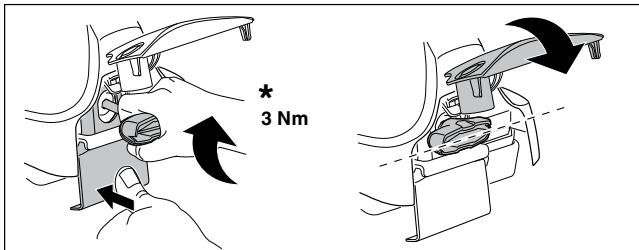
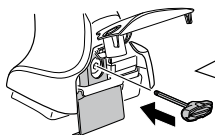

*
3 Nm

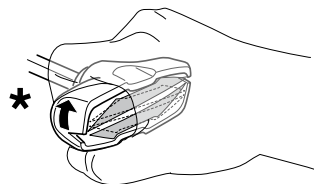

*

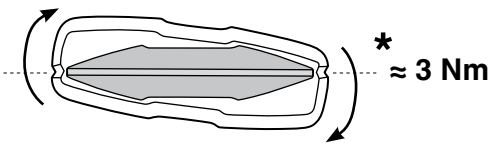

*
≈ 3 Nm

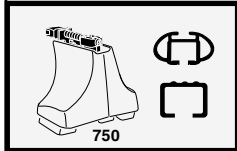
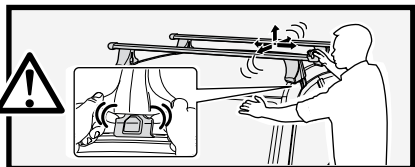

750

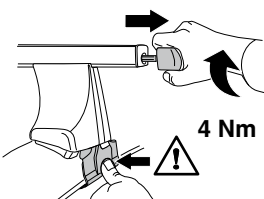

4 Nm

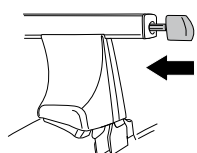

7

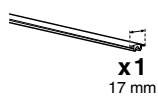

x1
17 mm

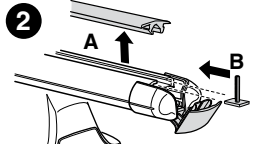
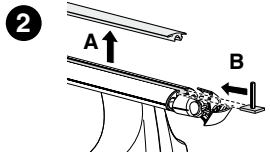
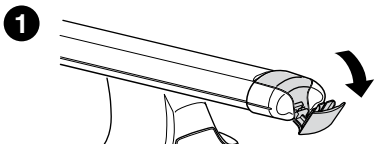
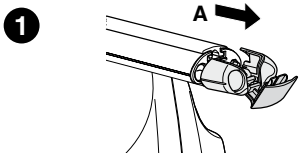
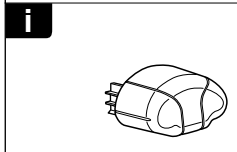
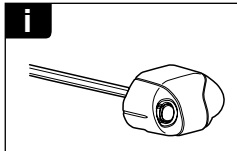
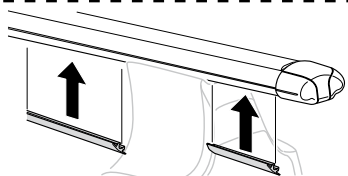



THULE
SWEDEN
**ONE
KEY
SYSTEM**



- 544 (x4)
- 596 (x6)
- 588 (x8)
- NA 510 (x10)
- EUR 452 (x12)
- ASIA



WW ▶ Thule Sweden AB, Box 69, 330 33 Hillerstorp, SWEDEN
NA ▶ Thule Inc., 42 Silvermine Road, Seymour, Connecticut 06483, USA

info@thule.com
customer.service@thule.com

www.thule.com



www.thuleprofessional.com



customer.service@thule.com



Thule Inc., 42 Silvermine Road, Seymour, Connecticut 06483, USA
Thule Sweden AB, Box 69, 330 33 Hillerstorp, SWEDEN

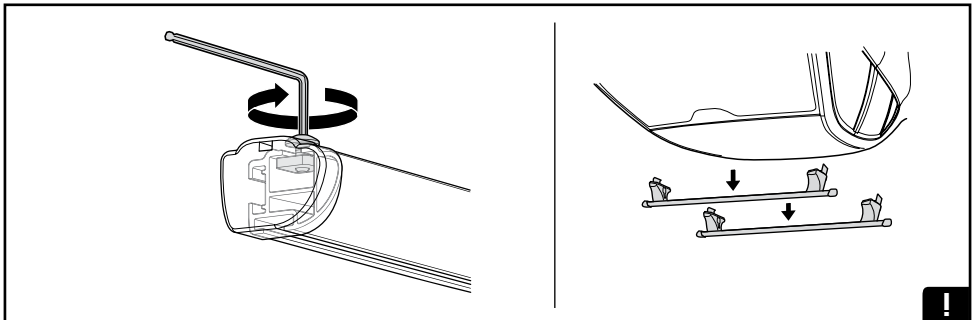
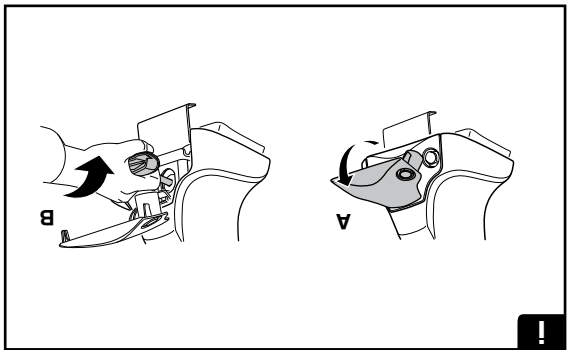
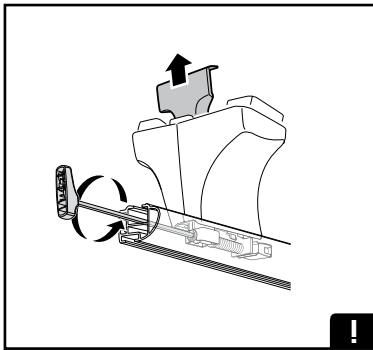
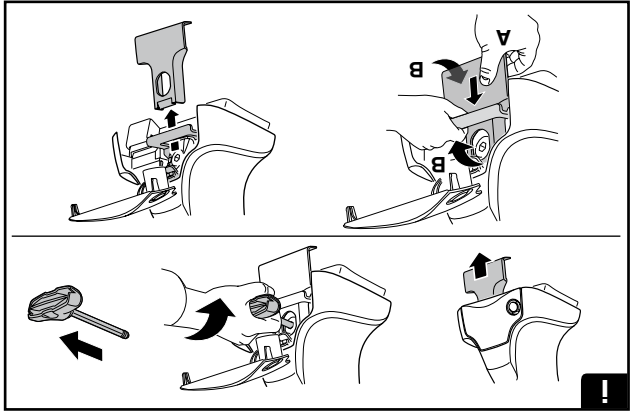
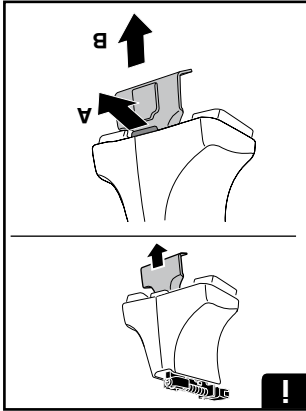

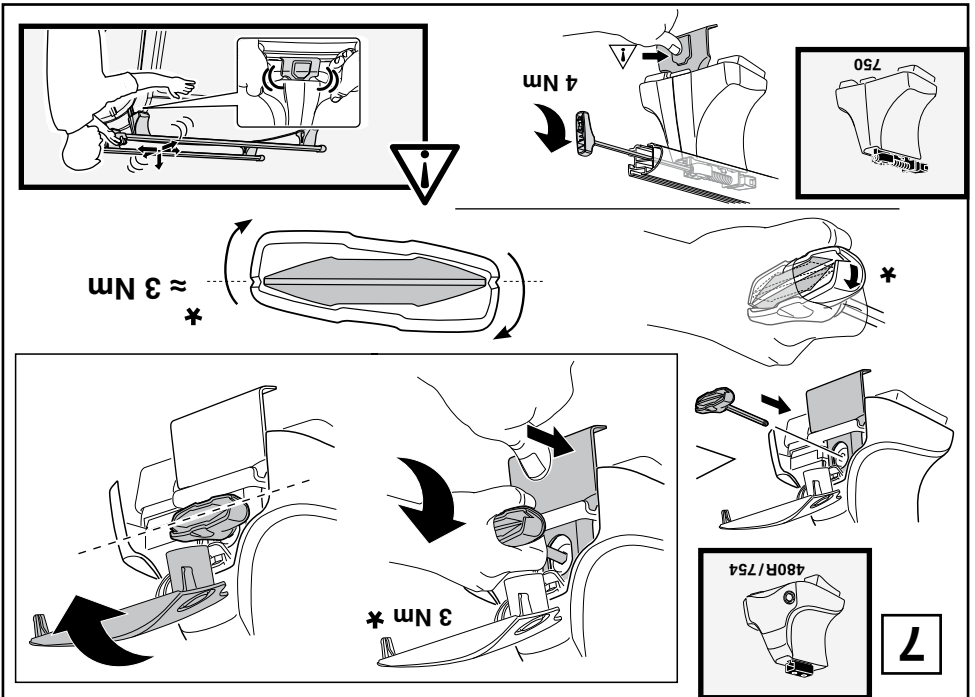
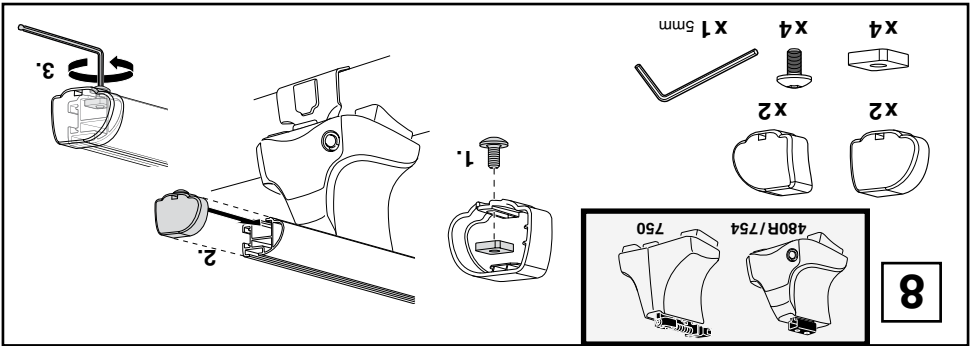
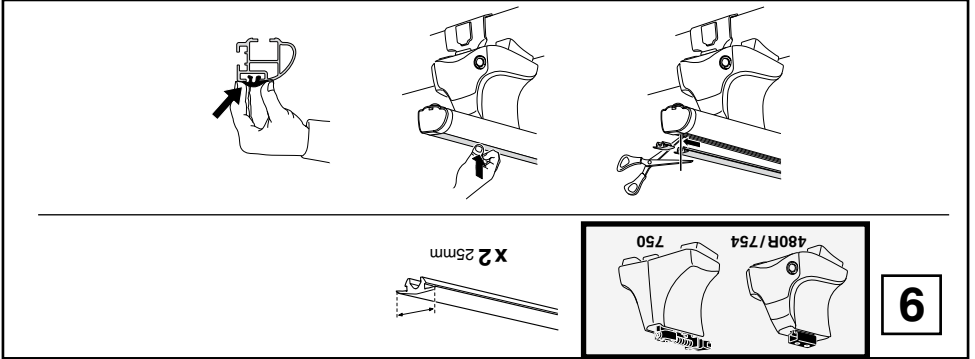

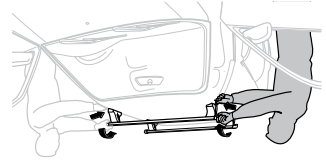

- GB/US Tighten alternately
- D Die Schrauben abwechselnd anziehen
- F Serrer alternativement chaque côté
- NL Afwisselend aan de linker- en de rechterkant aandraaien
- I Alterare il serraggio delle viti
- E Apretar alternativamente
- PT Aperte alternadamente
- S Dra åt växelvis
- FIN Kierrä vuorotellen
- EST Pinguldage vaheldumisi
- LAT Pieviciet pamīsus
- LIT Užsukinkite pakaitomis
- PL Śruby dokręcaj naprzemiennie
- RU Затягивайте попеременно

- CZ Pokrýtá bagazníka dokręcaj
- SK Dotiahňte štriedavo
- SLO Privijajte izmenično
- HR Najzajmnično zategnite
- HU Egyrésztől függetlenül
- GR Σφίγγετε εναλλάξ
- TR Donuşumlu sıkın
- 中文 交替拧紧
- 한국어 번갈아 가며 조이십시오.
- 日本語 交互に締め付けてください。
- ᲓᲠᲗᲚᲛᲗᲚᲛᲗᲚᲛ

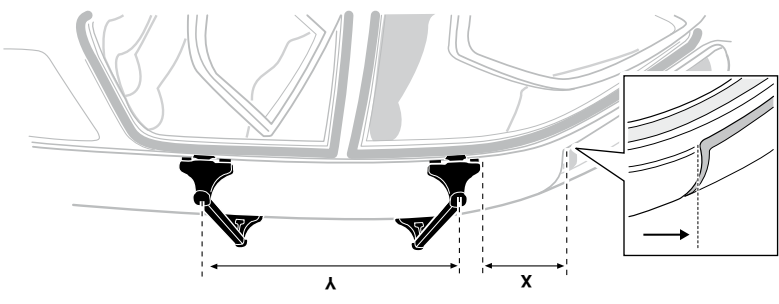
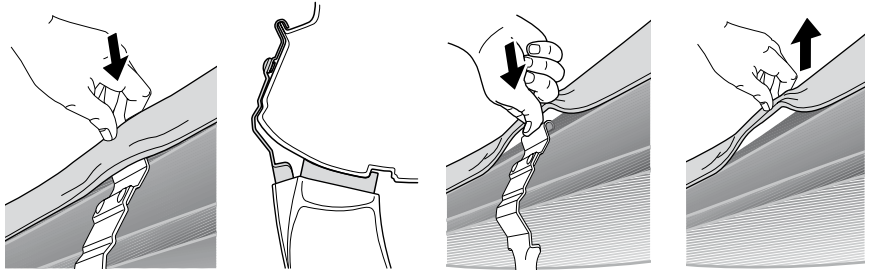

	X mm	Y mm	X inch	Y inch
NISSAN King Cab, 4-dr Pickup Double Cab, 05-	260 mm	750 mm	10 1/4"	29 1/2"
NISSAN Navara, 4-dr Pickup Double Cab, 05-	260 mm	750 mm	10 1/4"	29 1/2"
NISSAN Pathfinder, 5-dr SUV, 05-	260 mm	750 mm	10 1/4"	29 1/2"

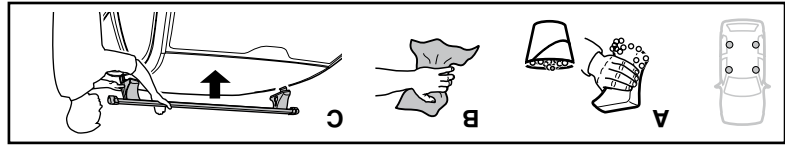

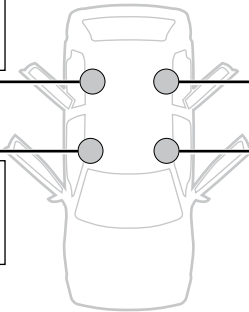
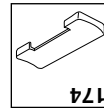
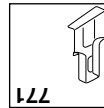
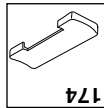
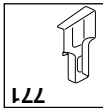
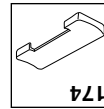
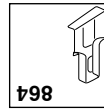
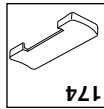
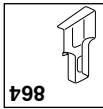
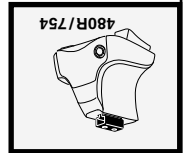
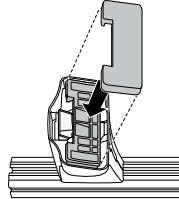
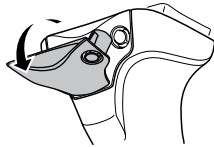
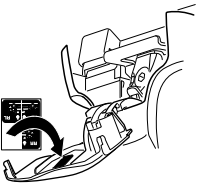
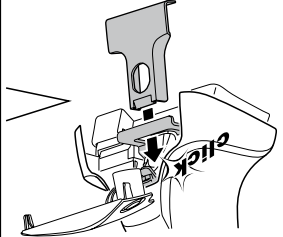
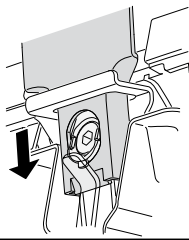
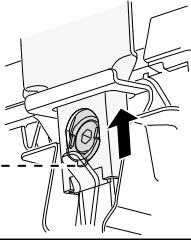
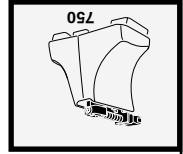
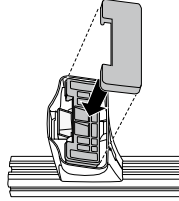
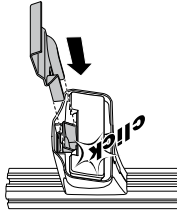
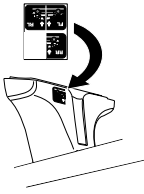

NISSAN King Cab, 4-dr Pickup Double Cab, 05-
NISSAN Navara, 4-dr Pickup Double Cab, 05-
NISSAN Pathfinder, 5-dr SUV, 05-

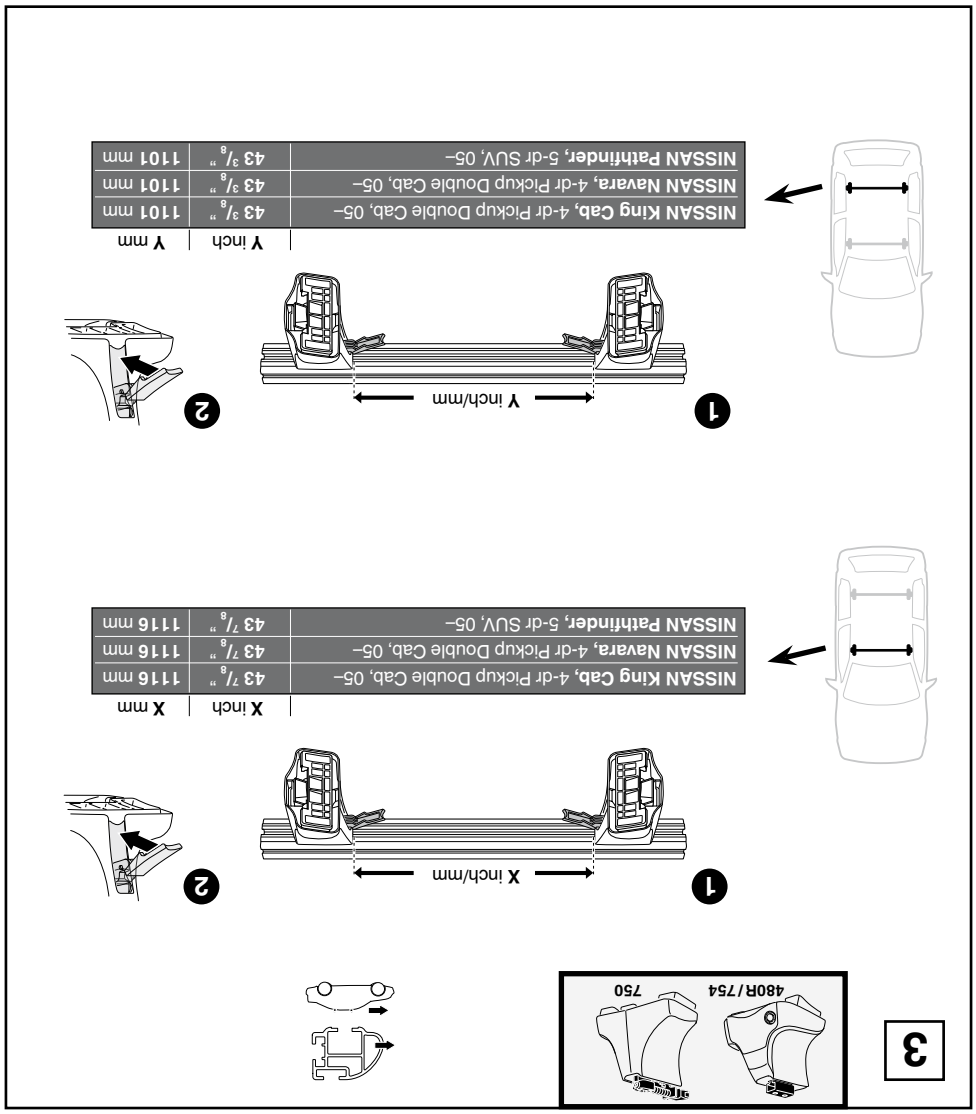
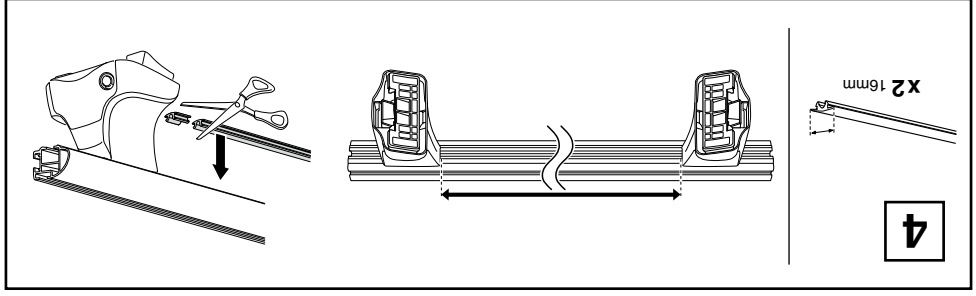

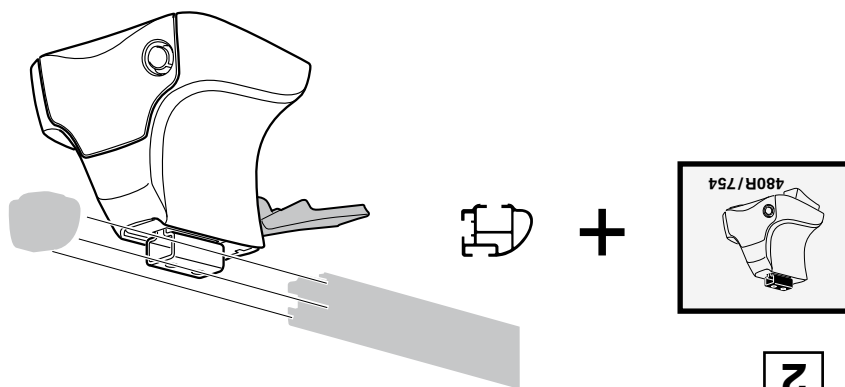
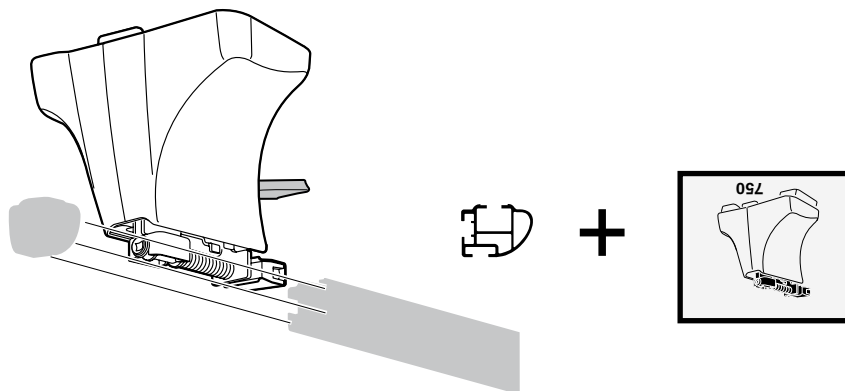

2

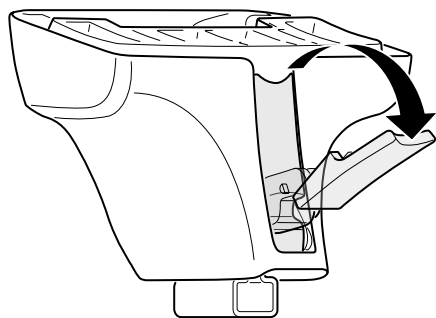

1

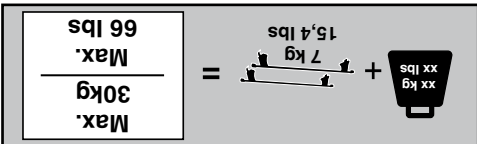
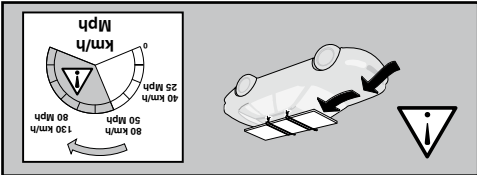
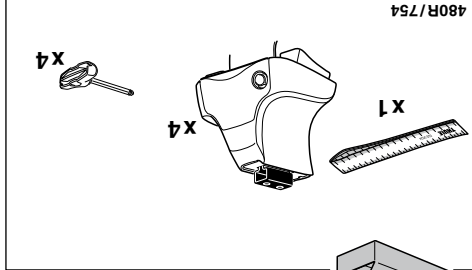
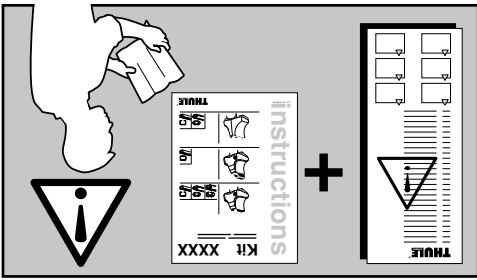
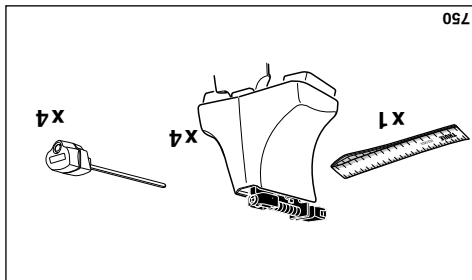
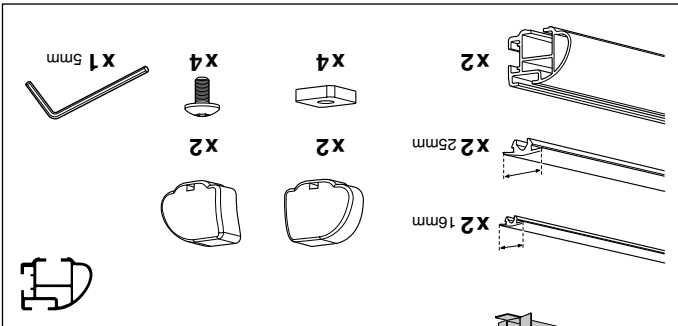
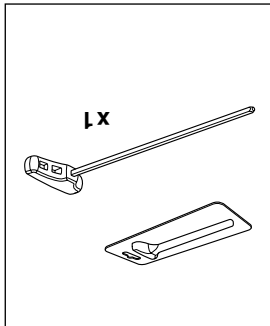
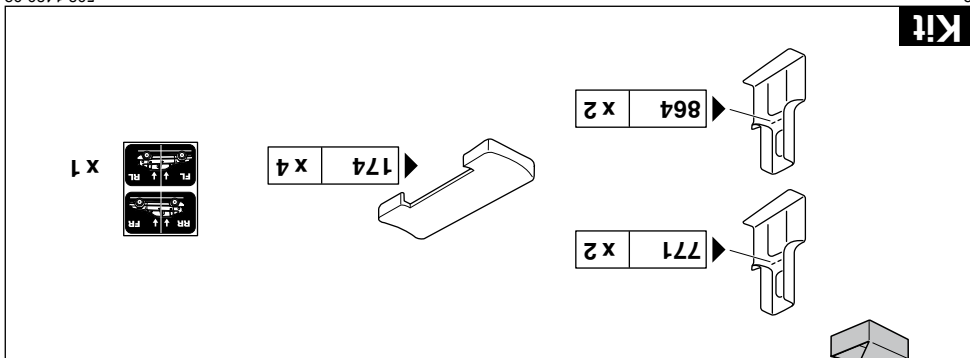

instructions

Kit 1430

NISSAN King Cab, 4-dr Pickup Double Cab, 05-*

NISSAN Navara, 4-dr Pickup Double Cab, 05-*

NISSAN Pathfinder, 5-dr SUV, 05-*

* Without roof railing

480R
754

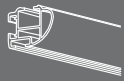
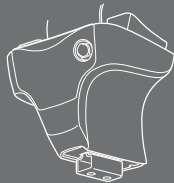

750

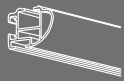
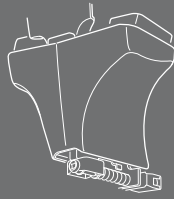

ISO 11154-E

PROFESSIONAL

THULE
SWEDEN