

Kit 1415

CHEVROLET Matiz, 5-dr Hatchback, 05-09

CHEVROLET Spark, 5-dr Hatchback, 05-09

480R
754

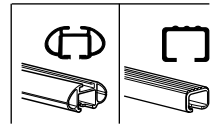
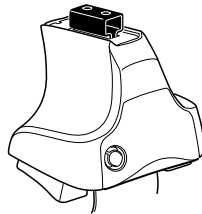

480

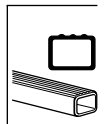
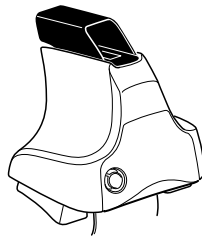

750

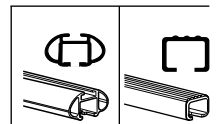
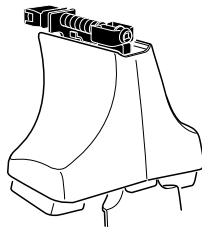

THULE[®]
SWEDEN

Kit

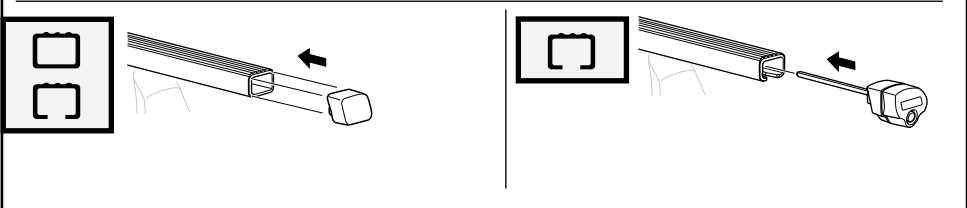
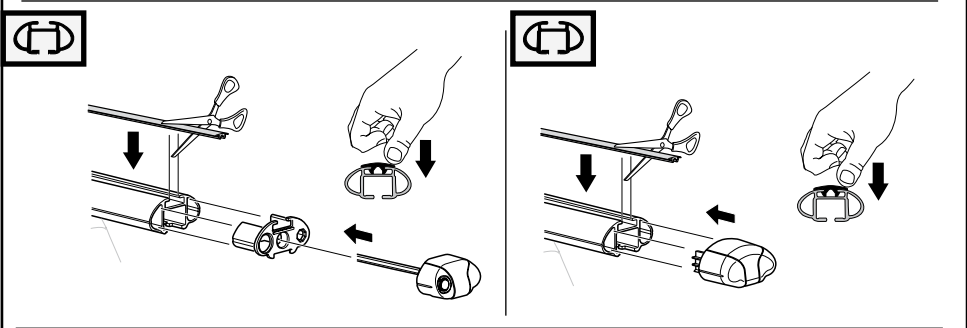
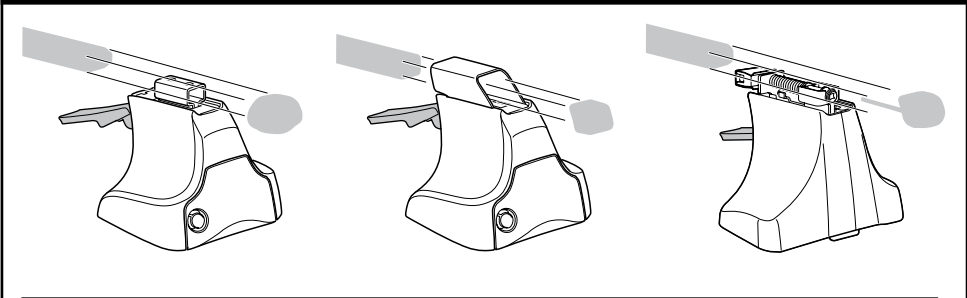
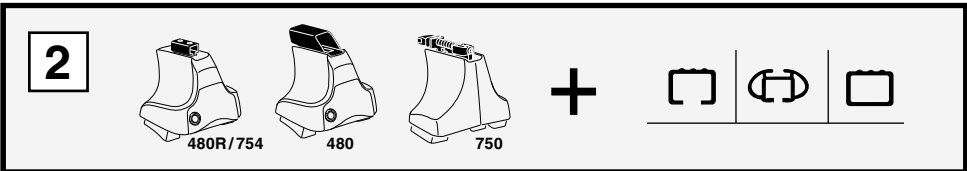
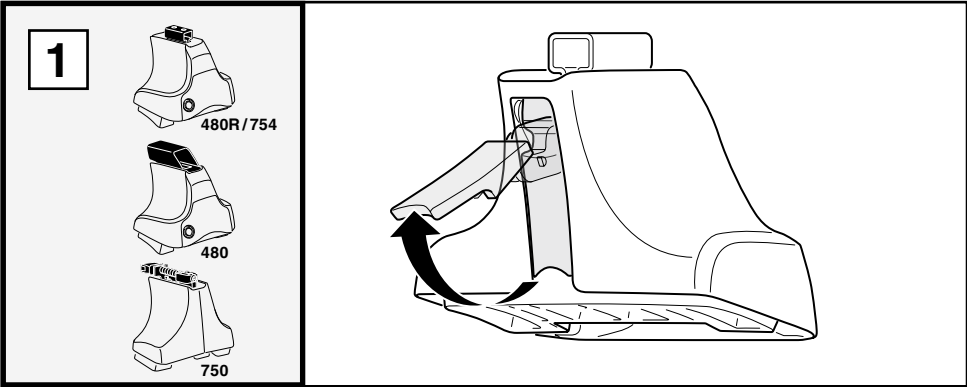

3

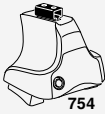

1

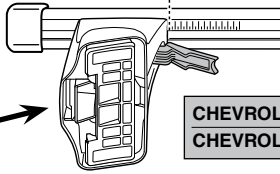
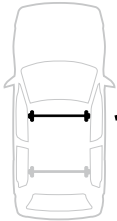

2

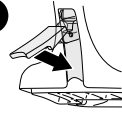

| | X |
|---|-----------|
| CHEVROLET Matiz, 5-dr Hatchback, 05-09 | 21 |
| CHEVROLET Spark, 5-dr Hatchback, 05-09 | 21 |

1

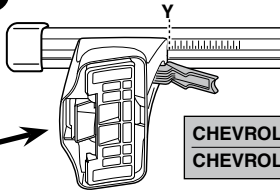

2

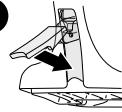

| | Y |
|---|-----------|
| CHEVROLET Matiz, 5-dr Hatchback, 05-09 | 18 |
| CHEVROLET Spark, 5-dr Hatchback, 05-09 | 18 |



480R



480

1

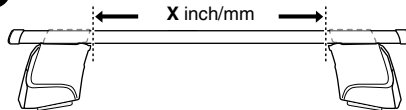
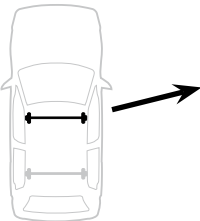

2

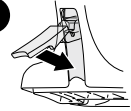

| | X inch | X mm |
|---|----------------|---------------|
| CHEVROLET Matiz, 5-dr Hatchback, 05-09 | 33 7/8" | 861 mm |
| CHEVROLET Spark, 5-dr Hatchback, 05-09 | 33 7/8" | 861 mm |

1

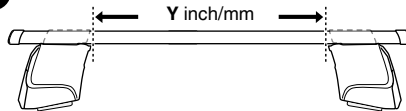
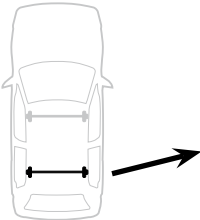

2

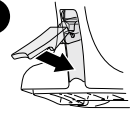

| | Y inch | Y mm |
|---|----------------|---------------|
| CHEVROLET Matiz, 5-dr Hatchback, 05-09 | 32 3/4" | 831 mm |
| CHEVROLET Spark, 5-dr Hatchback, 05-09 | 32 3/4" | 831 mm |

4

CHEVROLET Matiz, 5-dr Hatchback, 05-09
CHEVROLET Spark, 5-dr Hatchback, 05-09

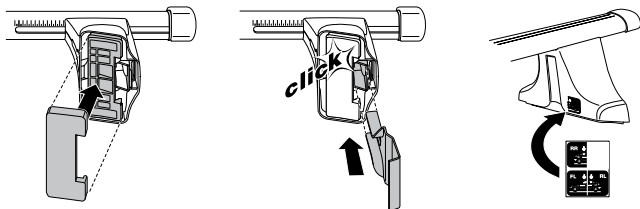
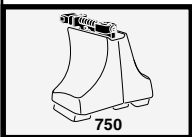
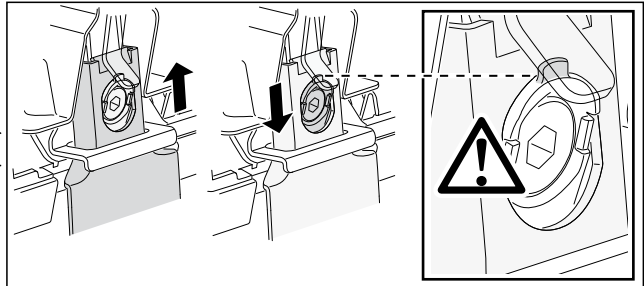
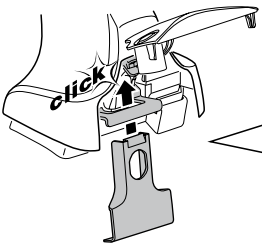
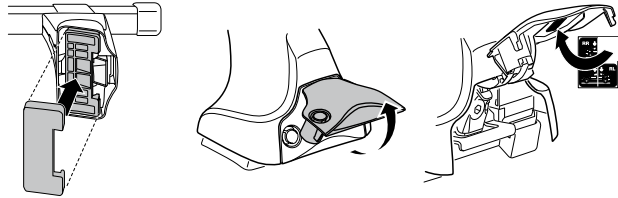
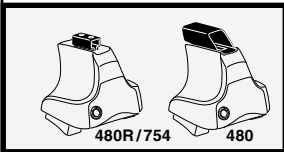
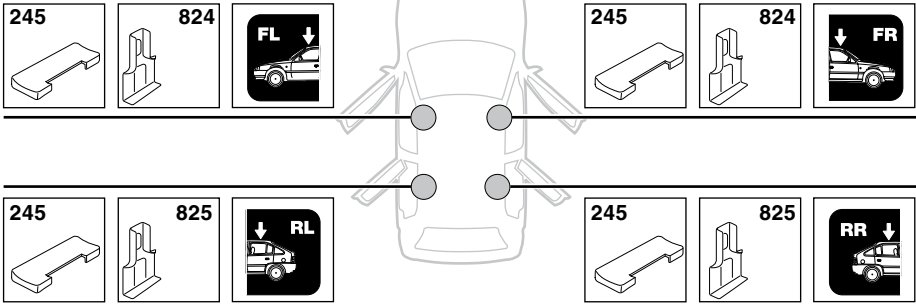

5

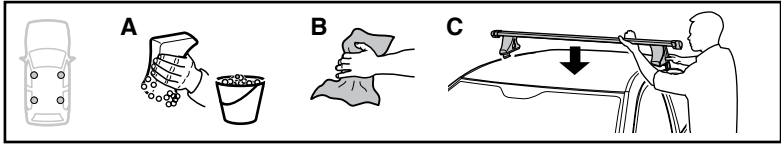

| | X mm | Y mm | X inch | Y inch |
|--|--------|--------|---------------------------------|----------------------------------|
| CHEVROLET Matiz , 5-dr Hatchback, 05-09 | 250 mm | 700 mm | 9 ⁷ / ₈ " | 27 ¹ / ₂ " |
| CHEVROLET Spark , 5-dr Hatchback, 05-09 | 250 mm | 700 mm | 9 ⁷ / ₈ " | 27 ¹ / ₂ " |

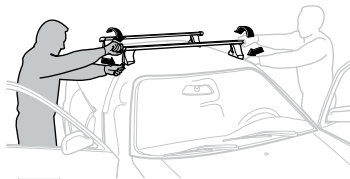
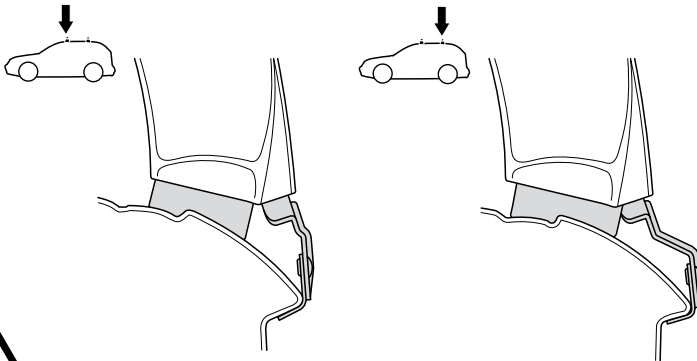
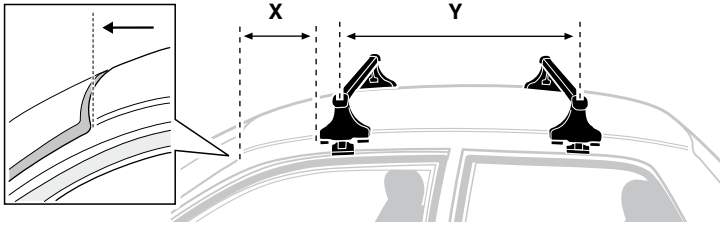

GB/US Tighten alternately

D Die Schrauben abwechselnd anziehen

F Serrer alternativement chaque côté

NL Afwisselend aan de linker- en de rechterkant aandraaien

I Alternare il serraggio delle viti

E Apretar alternativamente

PT Aperte alternadamente

S Dra åt växelvis

FIN Kierrä vuorotellen

EST Pinguldage vaheldumisi

LAT Pielieciet pamišus

LIT Užsukinėkite pakaitomis

PL Śruby dokręcaj naprzemiennie

RU Затягивайте попеременно

CZ Pokręťta bagażníka dokręcaj dokręcaj naprzemiennie.

SK Doťahujte striedavo

SLO Privijajte izmenično.

HR Naizmjenično zategnite

HU Egymástól függetlenül szorítandó

GR Σφίγγετε εναλλάξ

TR Dönüşümlü sıkın

中文 交替拧紧

한국어 번갈아 가며 조이십시오.

日本語 交互に締め付けてください。

ไทย ชั้้นในแบบสลับ

6

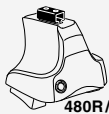

480R/754



480

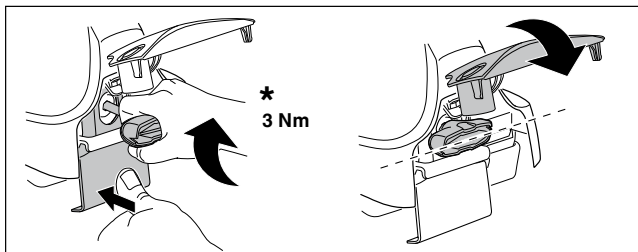
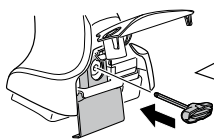

*
3 Nm

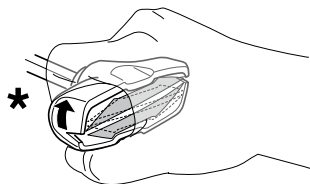

*

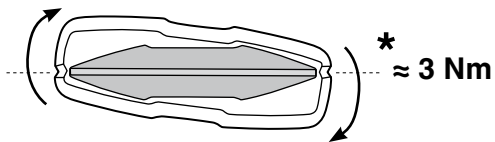

*
≈ 3 Nm

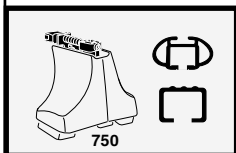
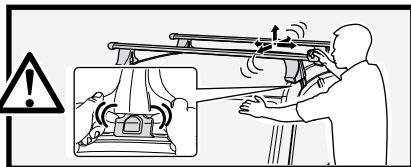

750

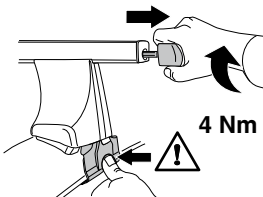

4 Nm

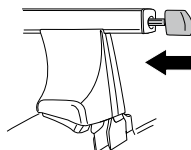

7



x1
17 mm

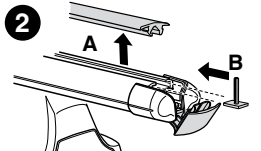
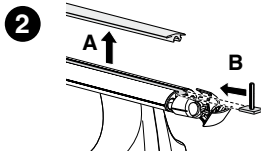
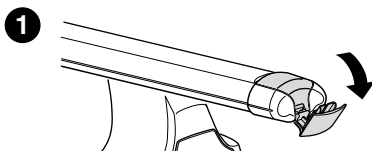
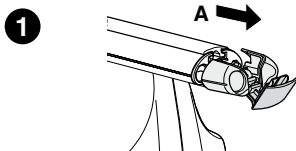
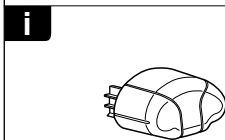
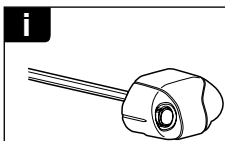
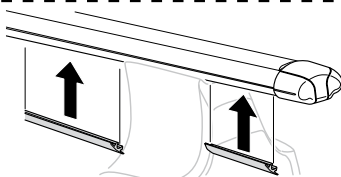

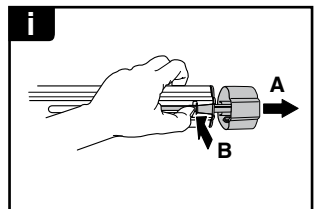
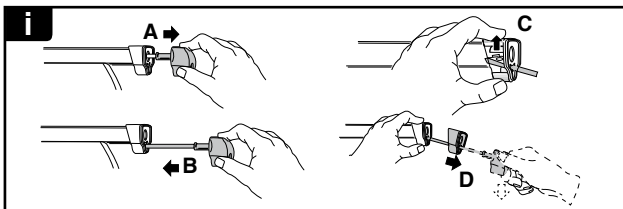
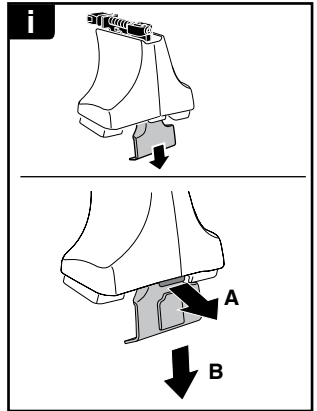
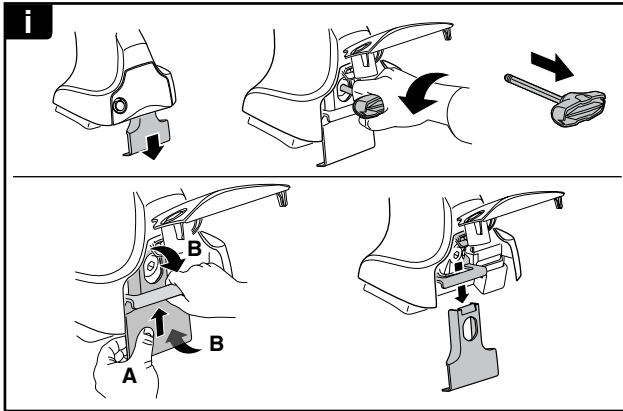
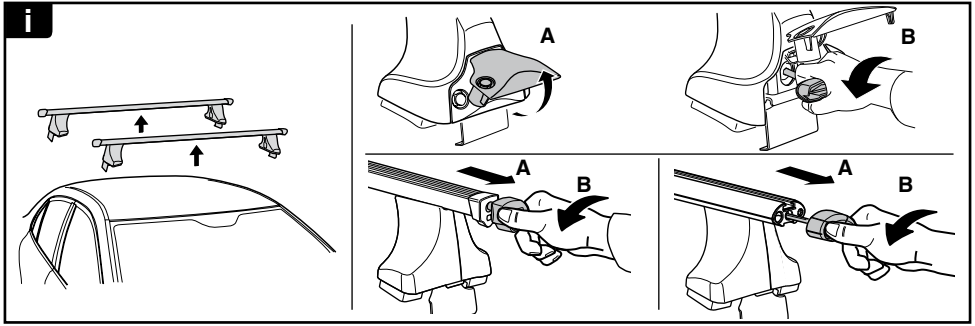

THULE
SWEDEN
**ONE
KEY
SYSTEM**

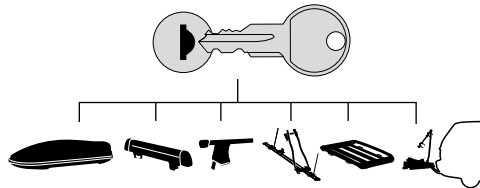

- 544 (x4)
- 596 (x6)
- 588 (x8)
- NA 510 (x10)
- EUR 452 (x12)
- ASIA

