

# Kit 1394

DAIHATSU Materia, 5-dr MPV, 07-  
TOYOTA bB, 5-dr MPV, 06-

480R  
754

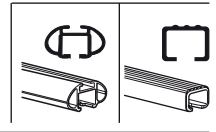
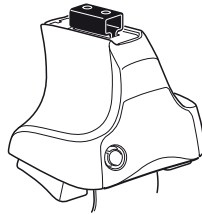

480

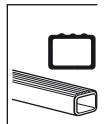
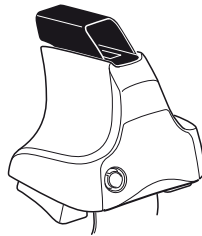

750

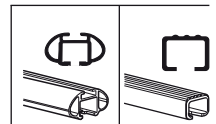
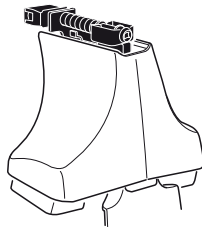

**Kit**

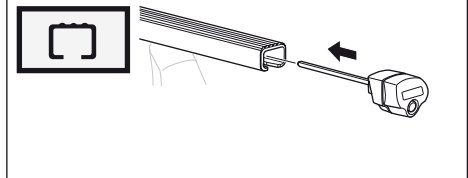
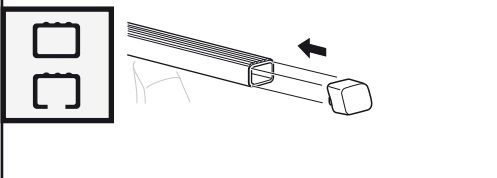
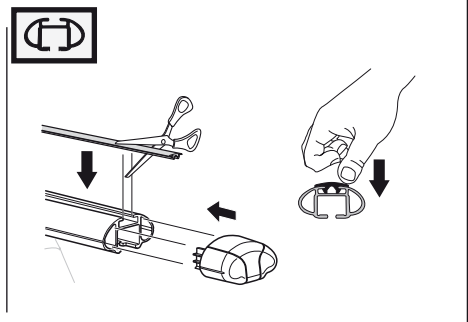
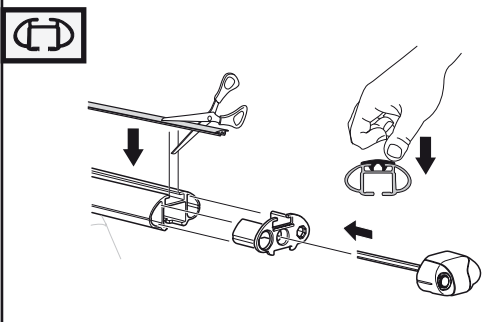
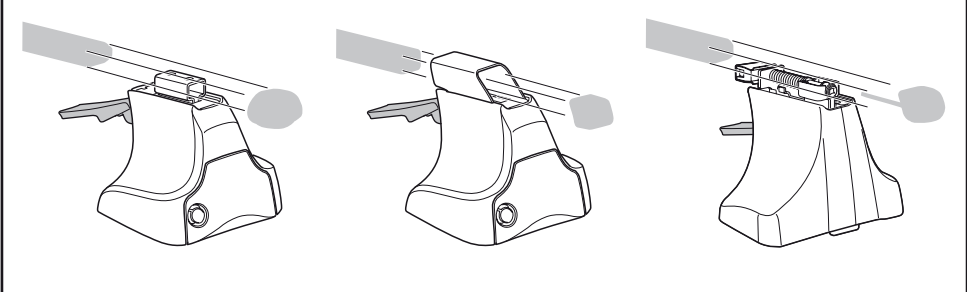
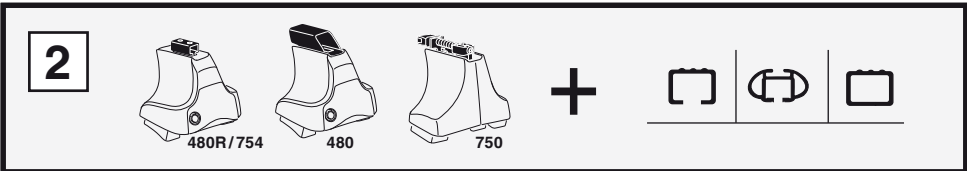
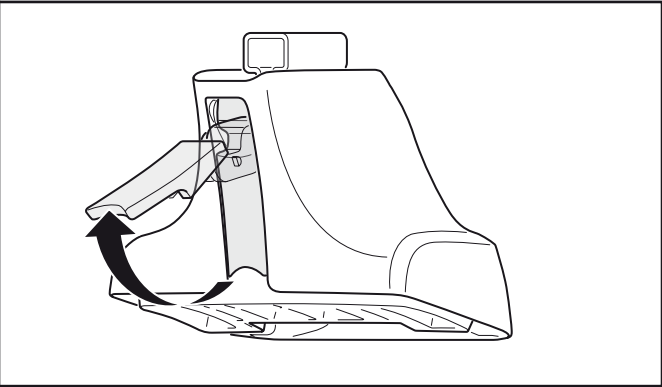
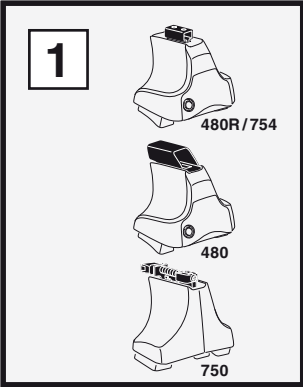

**3**



**1**

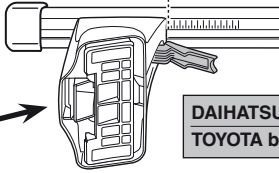
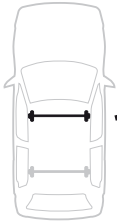

**2**

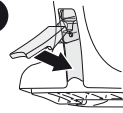

	X	
DAIHATSU Materia, 5-dr MPV, 07–	38,5	
TOYOTA bB, 5-dr MPV, 06–	38,5	

**1**

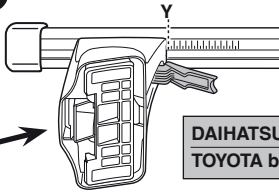

**2**

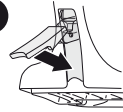

	Y	
DAIHATSU Materia, 5-dr MPV, 07–	36,5	
TOYOTA bB, 5-dr MPV, 06–	36,5	



480R



480

**1**

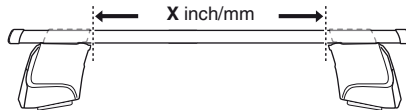
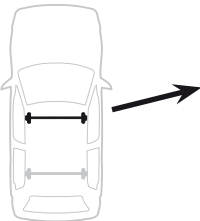

**2**

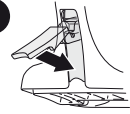

	X inch	X mm
DAIHATSU Materia, 5-dr MPV, 07–	40 <sup>3</sup> / <sub>4</sub> "	1036 mm
TOYOTA bB, 5-dr MPV, 06–	40 <sup>3</sup> / <sub>4</sub> "	1036 mm

**1**

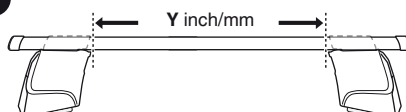
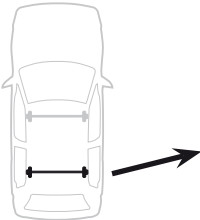

**2**

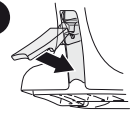

	Y inch	Y mm
DAIHATSU Materia, 5-dr MPV, 07–	40"	1016 mm
TOYOTA bB, 5-dr MPV, 06–	40"	1016 mm

# 4

DAIHATSU Materia, 5-dr MPV, 07-  
TOYOTA bB, 5-dr MPV, 06-

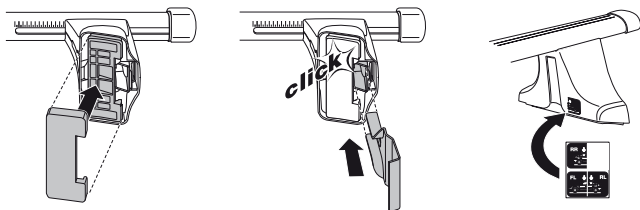
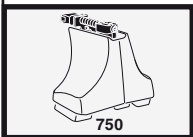
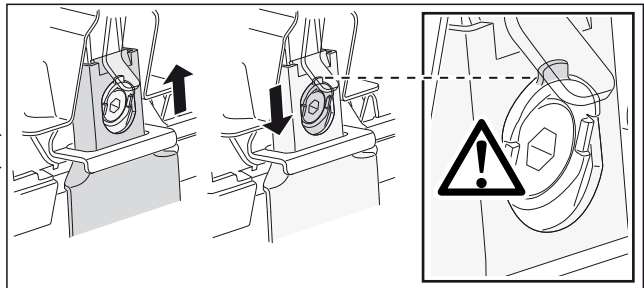
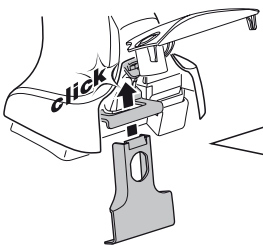
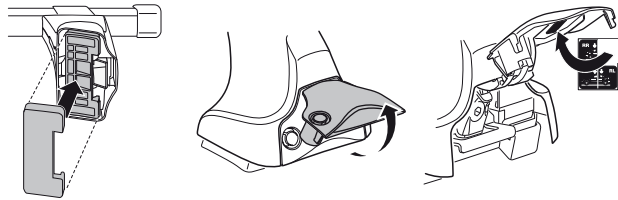
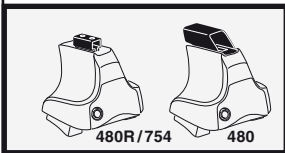
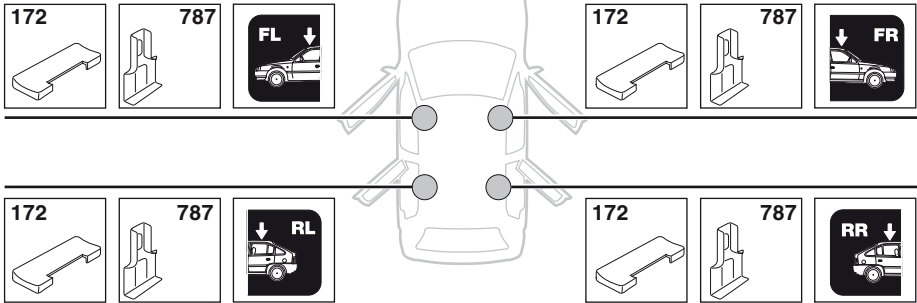

5



	X mm	Y mm	X inch	Y inch
<b>DAIHATSU</b> Materia, 5-dr MPV, 07-	485 mm	710 mm	19 1/8"	28"
<b>TOYOTA</b> bB, 5-dr MPV, 06-	485 mm	710 mm	19 1/8"	28"

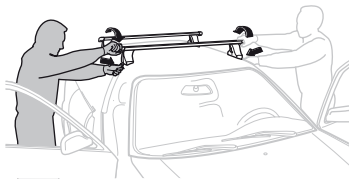
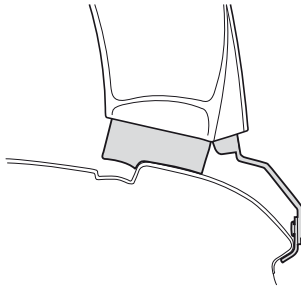
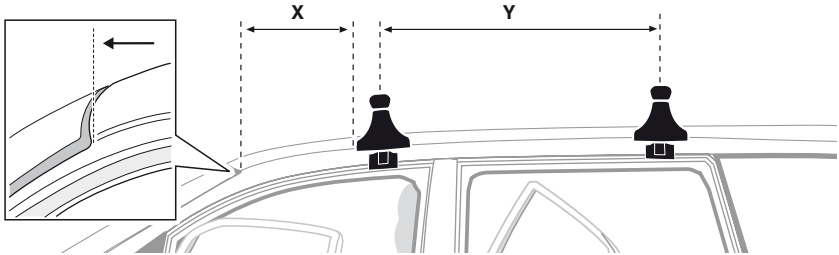

**GB/US** Tighten alternately

**D** Die Schrauben abwechselnd anziehen

**F** Serrer alternativement chaque côté

**NL** Afwisselend aan de linker- en de rechterkant aandraaien

**I** Alternare il serraggio delle viti

**E** Apretar alternativamente

**PT** Aperte alternadamente

**S** Dra åt växelvis

**FIN** Kierrä vuorotellen

**EST** Pinguldage vaheldumisi

**LAT** Pielvelciet pamīšus

**LIT** Užsukinėkite pakaitomis

**PL** Śruby dokręcaj naprzemiennie

**RU** Затягивайте попеременно

**CZ** Pokręťta багаžníka dokręcaj dokręcaj naprzemiennie.

**SK** Doťahujte striedavo

**SLO** Privijajte izmenično.

**HR** Naizmjenično zategnite

**HU** Egymástól függetlenül szorítandó

**GR** Σφίγγετε εναλλάξ

**TR** Dönüşümlü sıkın

**中文** 交替拧紧

**한국어** 번갈아 가며 조이십시오.

**日本語** 交互に締め付けてください。

**ไทย** ชั้้นโน้แบบสลับ

6



480R/754



480

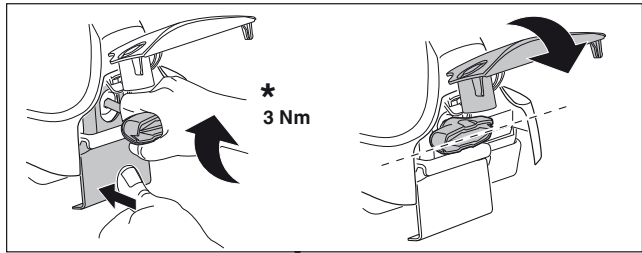
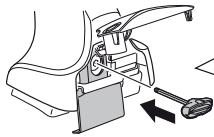

\*  
3 Nm

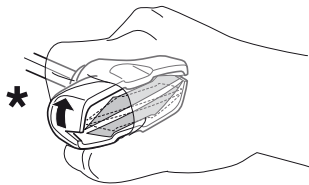

\*

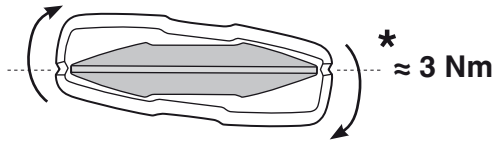

\*  
≈ 3 Nm

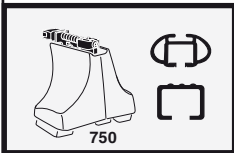
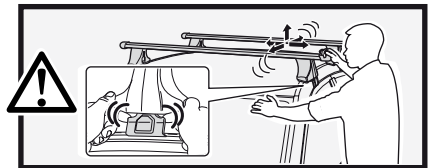

750

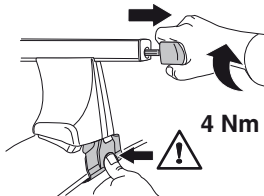

4 Nm

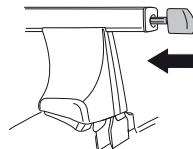

7



x1  
17 mm

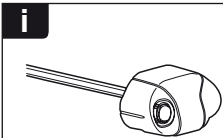
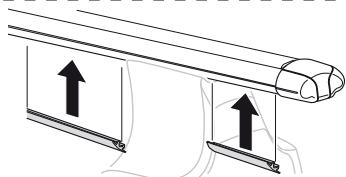

i

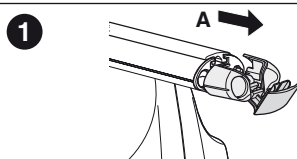

1

A →

↓ B

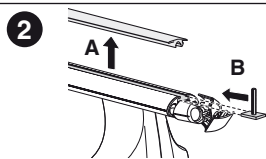

2

A ↑

← B

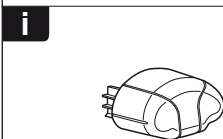

i

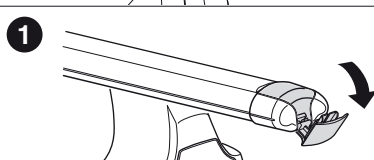

1

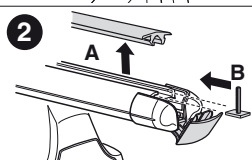

2

A ↑

← B

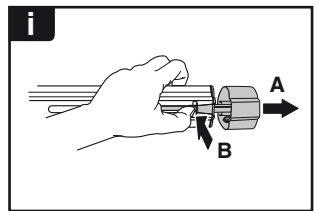
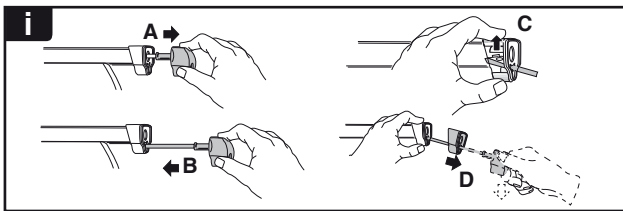
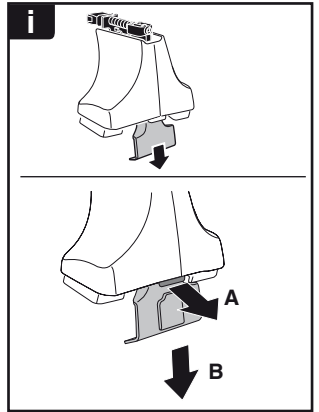
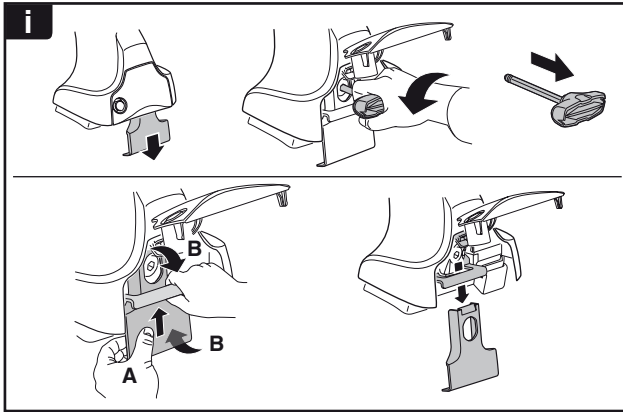

**THULE**  
SWEDEN  
**ONE  
KEY  
SYSTEM**

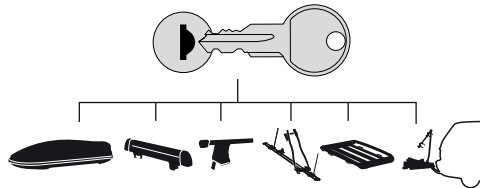

- 544 (x4)
- 596 (x6)
- 588 (x8)
- NA 510 (x10)
- EUR 452 (x12)
- ASIA



WW ▶ Thule Sweden AB, Box 69, 330 33 Hillerstorp, SWEDEN  
NA ▶ Thule Inc., 42 Silvermine Road, Seymour, Connecticut 06483, USA

info@thule.com  
customer.service@thule.com

www.thule.com