

# Kit 1353

TOYOTA Corolla Spacio III, 5-dr MPV, 04-08

TOYOTA Corolla Verso III, 5-dr MPV, 04-08

TOYOTA Verso, 5-dr MPV, 09-

480R  
754

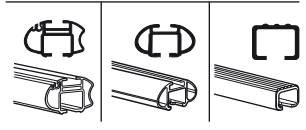
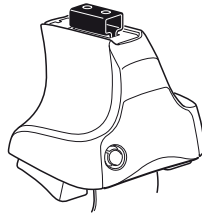

480

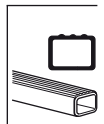
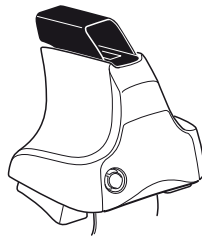

750

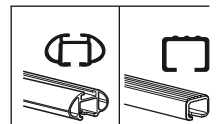
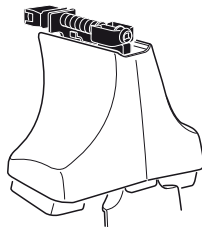

**Kit**



3

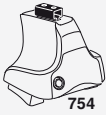

754

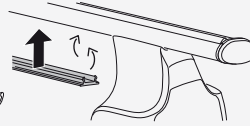
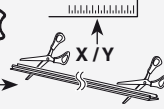

750



1

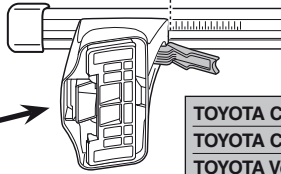
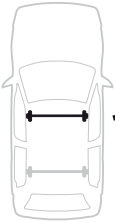

2



	X
TOYOTA Corolla Spacio III, 5-dr MPV, 04-08	47,5
TOYOTA Corolla Verso III, 5-dr MPV, 04-08	47,5
TOYOTA Verso, 5-dr MPV, 09-	47,5

1

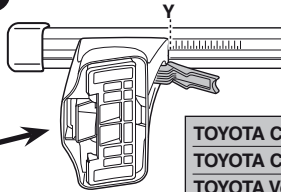

2

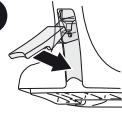

	Y
TOYOTA Corolla Spacio III, 5-dr MPV, 04-08	41
TOYOTA Corolla Verso III, 5-dr MPV, 04-08	41
TOYOTA Verso, 5-dr MPV, 09-	44



480R



480

1

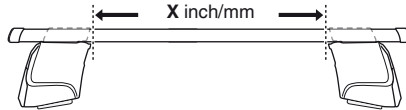
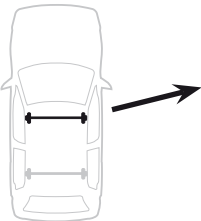

2

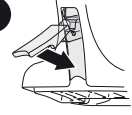

	X inch	X mm
TOYOTA Corolla Spacio III, 5-dr MPV, 04-08	44 <sup>3</sup> / <sub>8</sub> "	1126 mm
TOYOTA Corolla Verso III, 5-dr MPV, 04-08	44 <sup>3</sup> / <sub>8</sub> "	1126 mm
TOYOTA Verso, 5-dr MPV, 09-	44 <sup>3</sup> / <sub>8</sub> "	1126 mm

1

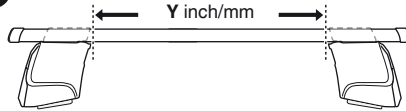
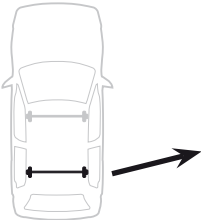

2

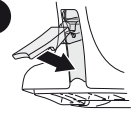

	Y inch	Y mm
TOYOTA Corolla Spacio III, 5-dr MPV, 04-08	41 <sup>3</sup> / <sub>8</sub> "	1061 mm
TOYOTA Corolla Verso III, 5-dr MPV, 04-08	41 <sup>3</sup> / <sub>8</sub> "	1061 mm
TOYOTA Verso, 5-dr MPV, 09-	43 "	1091 mm

# 4

TOYOTA Corolla Spacio III, 5-dr MPV, 04-08

TOYOTA Corolla Verso III, 5-dr MPV, 04-08

TOYOTA Verso, 5-dr MPV, 09-

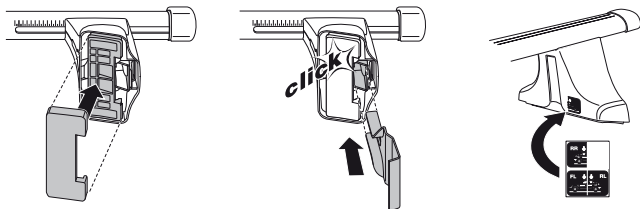
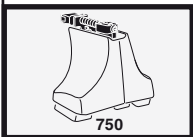
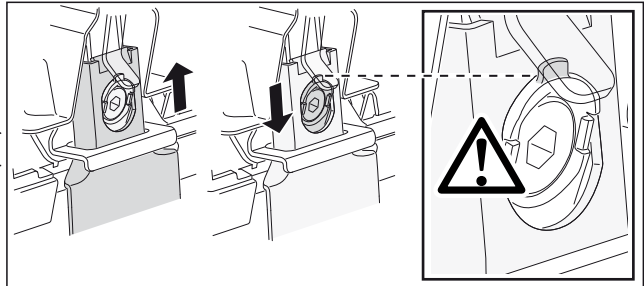
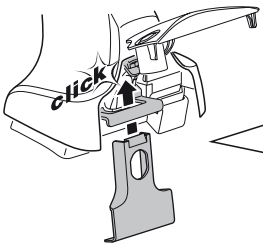
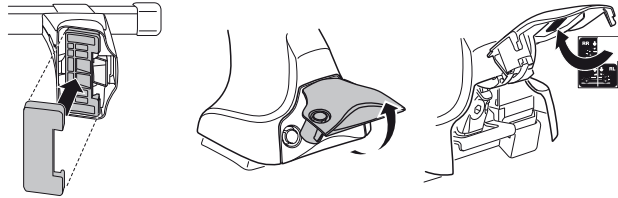
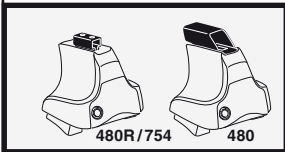
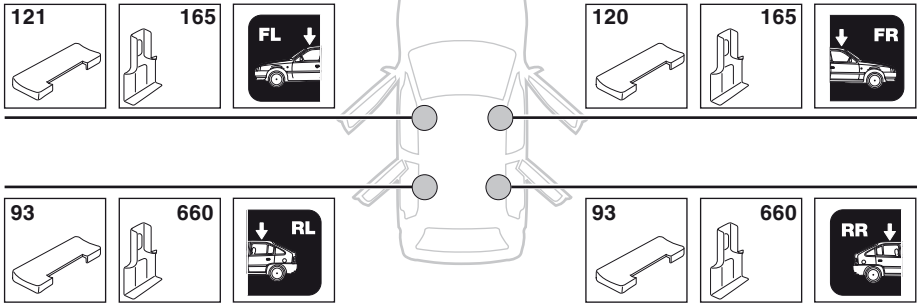

5



	X mm	Y mm	X inch	Y inch
TOYOTA Corolla Spacio III, 5-dr MPV, 04-08	330 mm	710 mm	13"	28"
TOYOTA Corolla Verso III, 5-dr MPV, 04-08	330 mm	710 mm	13"	28"
TOYOTA Verso, 5-dr MPV, 09-	330 mm	710 mm	13"	28"

TOYOTA Corolla Spacio III, 5-dr MPV, 04-08

TOYOTA Corolla Verso III, 5-dr MPV, 04-08

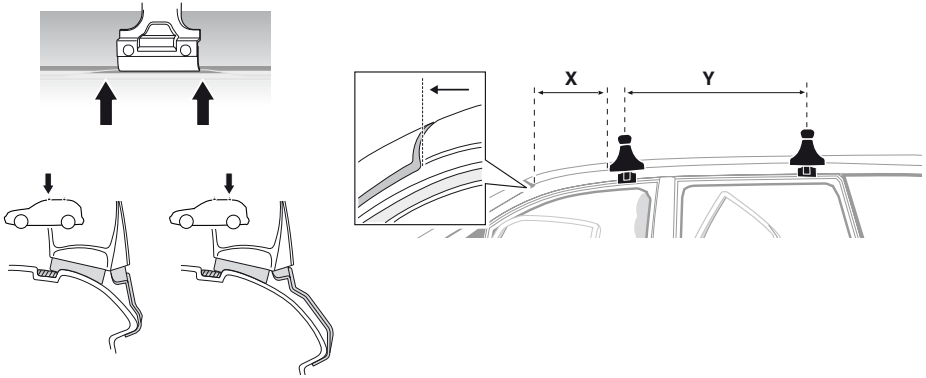

TOYOTA Verso, 5-dr MPV, 09-

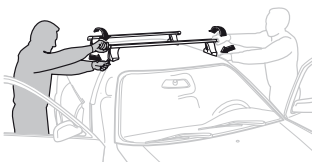
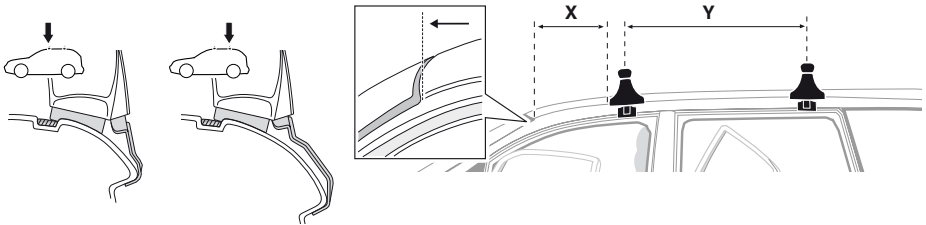

- GB/US** Tighten alternately  
**D** Die Schrauben abwechselnd anziehen  
**F** Serrer alternativement chaque côté  
**NL** Afwisselend aan de linker- en de rechterkant aandraaien  
**I** Alternare il serraggio delle vite  
**E** Apretar alternativamente  
**PT** Aperte alternadamente  
**S** Dra åt växelvis  
**FIN** Kierrä vuorotellen  
**EST** Pinguldage vaheldumisi  
**LAT** Pievelciēt pamišus  
**LIT** Užsukinėkite pakaitomis  
**PL** Śruby dokręcaj naprzemiennie  
**RU** Затягивайте попеременно

- CZ** Pokręťta багаžníka dokręcaj dokręcaj naprzemiennie.  
**SK** Dofahujte striedavo  
**SLO** Privijajte izmenično.  
**HR** Naizmjenično zategnite  
**HU** Egy mástól függetlenül szorítandó  
**GR** Σφιγγείτε εναλλάξ  
**TR** Dönüşümlü sıkın

**中文** 交替拧紧

**한국어** 번갈아 가며 조이십시오.

**日本語** 交互に締め付けてください。

**ไทย** ชั้้นในแบบสลับ

6



480R/754



480

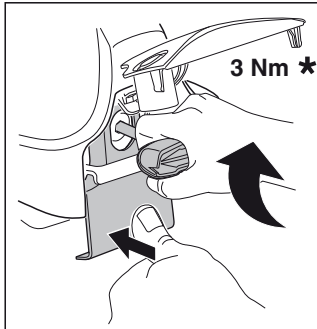
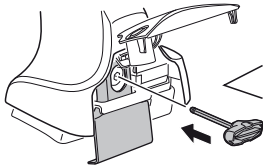

3 Nm \*

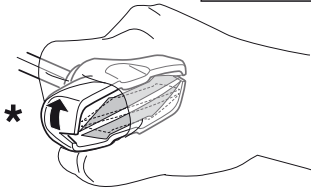
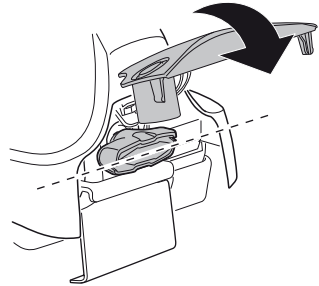

\*

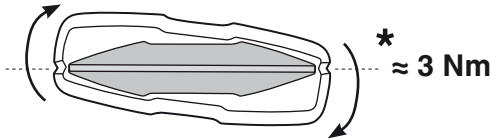

\* ≈ 3 Nm



750

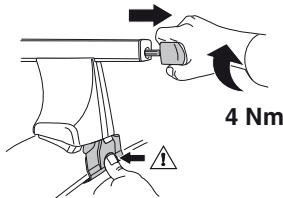

4 Nm

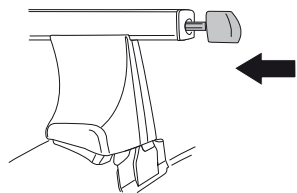

i



1

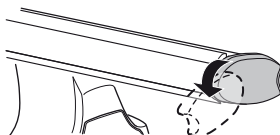

2

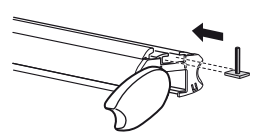

i

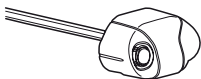

1

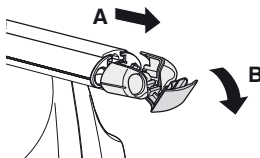

2

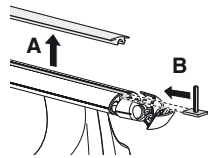

i



1

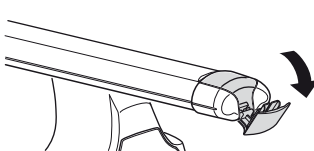

2

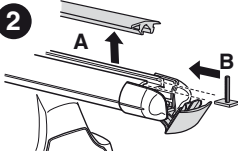



**THULE**  
SWEDEN  
**ONE  
KEY  
SYSTEM**



- 544 (x4)
- 596 (x6)
- 588 (x8)
- NA 510 (x10)
- EUR 452 (x12)
- ASIA



WW ▶ Thule Sweden AB, Box 69, 330 33 Hillerstorp, SWEDEN  
 NA ▶ Thule Inc., 42 Silvermine Road, Seymour, Connecticut 06483, USA

info@thule.com  
 customer.service@thule.com

www.thule.com