

# Kit 1338

- BUICK Excelle**, 5-dr Hatchback, 04-
- BUICK Excelle**, 4-dr Sedan, 04-
- CHEVROLET Lacetti**, 5-dr Hatchback, 04-
- CHEVROLET Nubira III**, 4-dr Sedan, 04-
- CHEVROLET Optra**, 5-dr Hatchback, 04-
- CHEVROLET Optra**, 4-dr Sedan, 04-
- DAEWOO Lacetti**, 5-dr Hatchback, 04-
- DAEWOO Lacetti**, 4-dr Sedan, 04-
- DAEWOO Nubira III**, 4-dr Sedan, 04-
- HOLDEN Viva**, 5-dr Hatchback, 04-
- HOLDEN Viva**, 4-dr Sedan, 04-

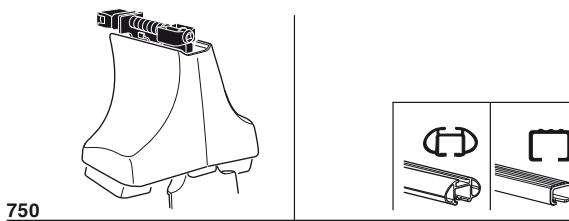

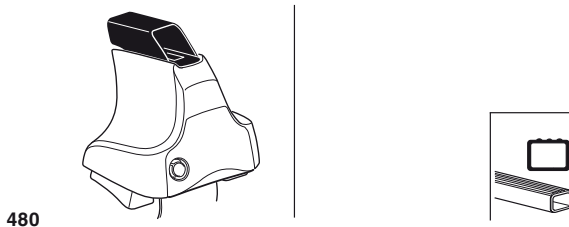
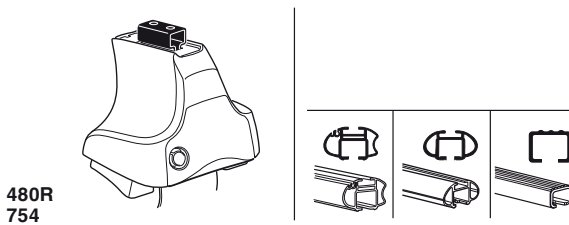

4-dr Sedan

Max. 30kg/66 lbs

5-dr Hatchback

Max. 40kg/88 lbs

40 km/h 25 Mph  
80 km/h 50 Mph  
130 km/h 80 Mph

km/h  
Mph

THULE Kit XXXX instructions

480R/754  
x1 x4 x4 x4

480  
x1 x4 x4 x4

750  
x1 x4 x4 x4

x2 x2 x2 x2 x4 x2 x2 x2 x4 x4

614 x1 638 x1 137 x4 615 x1 639 x1

FR FL RL RR

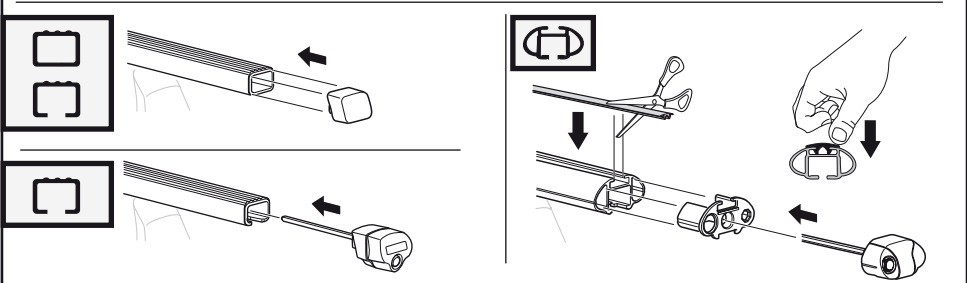
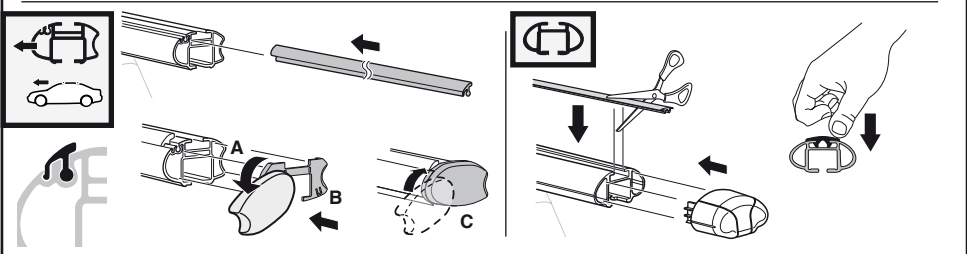
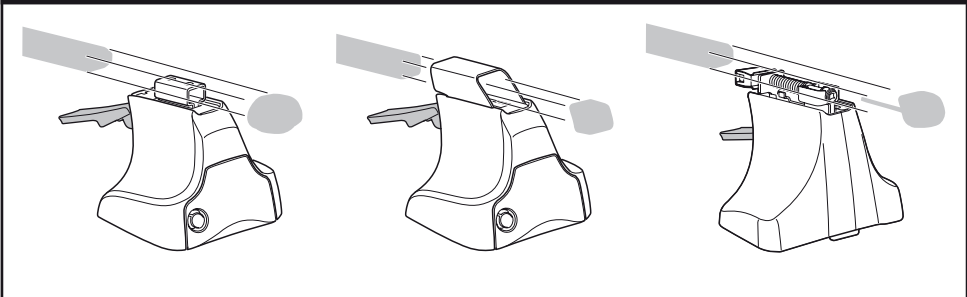
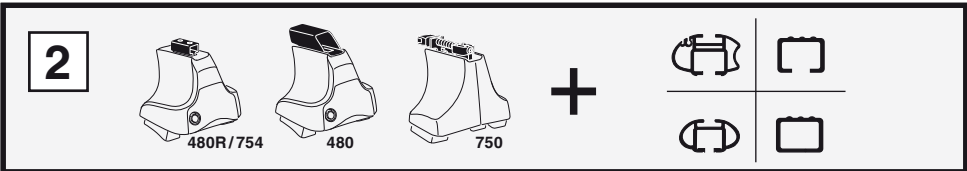
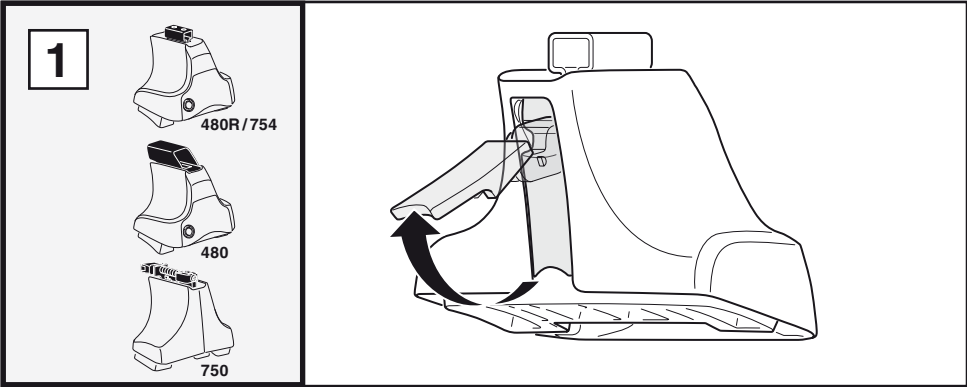

3

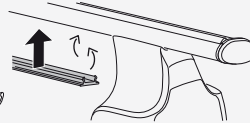
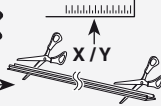

1

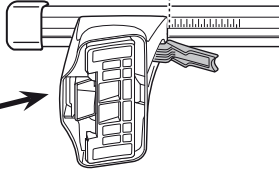

2

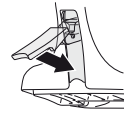

	X
<b>BUICK Excelle</b> , 5-dr Hatchback, 04-	30
<b>BUICK Excelle</b> , 4-dr Sedan, 04-	30
<b>CHEVROLET Lacetti</b> , 5-dr Hatchback, 04-	30
<b>CHEVROLET Nubira III</b> , 4-dr Sedan, 04-	30
<b>CHEVROLET Optra</b> , 5-dr Hatchback, 04-	30
<b>CHEVROLET Optra</b> , 4-dr Sedan, 04-	30
<b>DAEWOO Lacetti</b> , 5-dr Hatchback, 04-	30
<b>DAEWOO Lacetti</b> , 4-dr Sedan, 04-	30
<b>DAEWOO Nubira III</b> , 4-dr Sedan, 04-	30
<b>HOLDEN Viva</b> , 5-dr Hatchback, 04-	30
<b>HOLDEN Viva</b> , 4-dr Sedan, 04-	30

1

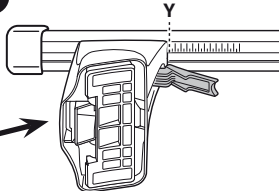
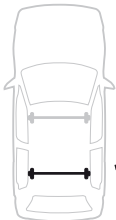

2

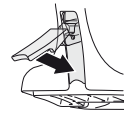

	Y
<b>BUICK Excelle</b> , 5-dr Hatchback, 04-	27
<b>BUICK Excelle</b> , 4-dr Sedan, 04-	28
<b>CHEVROLET Lacetti</b> , 5-dr Hatchback, 04-	27
<b>CHEVROLET Nubira III</b> , 4-dr Sedan, 04-	28
<b>CHEVROLET Optra</b> , 5-dr Hatchback, 04-	27
<b>CHEVROLET Optra</b> , 4-dr Sedan, 04-	28
<b>DAEWOO Lacetti</b> , 5-dr Hatchback, 04-	27
<b>DAEWOO Lacetti</b> , 4-dr Sedan, 04-	28
<b>DAEWOO Nubira III</b> , 4-dr Sedan, 04-	28
<b>HOLDEN Viva</b> , 5-dr Hatchback, 04-	27
<b>HOLDEN Viva</b> , 4-dr Sedan, 04-	28

**3**



480R



480

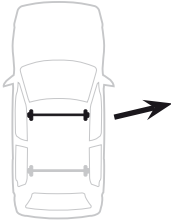
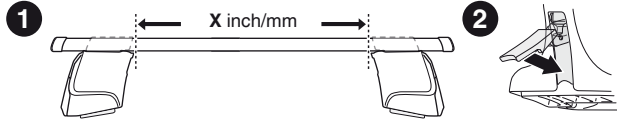

	X inch	X mm
<b>BUICK Excelle</b> , 5-dr Hatchback, 04-	<b>37 1/2"</b>	<b>951 mm</b>
<b>BUICK Excelle</b> , 4-dr Sedan, 04-	<b>37 1/2"</b>	<b>951 mm</b>
<b>CHEVROLET Lacetti</b> , 5-dr Hatchback, 04-	<b>37 1/2"</b>	<b>951 mm</b>
<b>CHEVROLET Nubira III</b> , 4-dr Sedan, 04-	<b>37 1/2"</b>	<b>951 mm</b>
<b>CHEVROLET Optra</b> , 5-dr Hatchback, 04-	<b>37 1/2"</b>	<b>951 mm</b>
<b>CHEVROLET Optra</b> , 4-dr Sedan, 04-	<b>37 1/2"</b>	<b>951 mm</b>
<b>DAEWOO Lacetti</b> , 5-dr Hatchback, 04-	<b>37 1/2"</b>	<b>951 mm</b>
<b>DAEWOO Lacetti</b> , 4-dr Sedan, 04-	<b>37 1/2"</b>	<b>951 mm</b>
<b>DAEWOO Nubira III</b> , 4-dr Sedan, 04-	<b>37 1/2"</b>	<b>951 mm</b>
<b>HOLDEN Viva</b> , 5-dr Hatchback, 04-	<b>37 1/2"</b>	<b>951 mm</b>
<b>HOLDEN Viva</b> , 4-dr Sedan, 04-	<b>37 1/2"</b>	<b>951 mm</b>

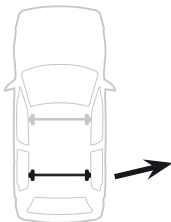
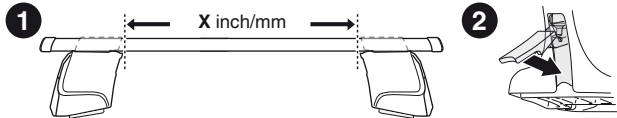

	Y inch	Y mm
<b>BUICK Excelle</b> , 5-dr Hatchback, 04-	<b>36 1/4"</b>	<b>921 mm</b>
<b>BUICK Excelle</b> , 4-dr Sedan, 04-	<b>36 5/8"</b>	<b>931 mm</b>
<b>CHEVROLET Lacetti</b> , 5-dr Hatchback, 04-	<b>36 1/4"</b>	<b>921 mm</b>
<b>CHEVROLET Nubira III</b> , 4-dr Sedan, 04-	<b>36 5/8"</b>	<b>931 mm</b>
<b>CHEVROLET Optra</b> , 5-dr Hatchback, 04-	<b>36 1/4"</b>	<b>921 mm</b>
<b>CHEVROLET Optra</b> , 4-dr Sedan, 04-	<b>36 5/8"</b>	<b>931 mm</b>
<b>DAEWOO Lacetti</b> , 5-dr Hatchback, 04-	<b>36 1/4"</b>	<b>921 mm</b>
<b>DAEWOO Lacetti</b> , 4-dr Sedan, 04-	<b>36 5/8"</b>	<b>931 mm</b>
<b>DAEWOO Nubira III</b> , 4-dr Sedan, 04-	<b>36 5/8"</b>	<b>931 mm</b>
<b>HOLDEN Viva</b> , 5-dr Hatchback, 04-	<b>36 1/4"</b>	<b>921 mm</b>
<b>HOLDEN Viva</b> , 4-dr Sedan, 04-	<b>36 5/8"</b>	<b>931 mm</b>

# 4

**BUICK Excelle**, 5-dr Hatchback, 04–  
**BUICK Excelle**, 4-dr Sedan, 04–  
**CHEVROLET Lacetti**, 5-dr Hatchback, 04–  
**CHEVROLET Nubira III**, 4-dr Sedan, 04–  
**CHEVROLET Optra**, 5-dr Hatchback, 04–  
**CHEVROLET Optra**, 4-dr Sedan, 04–

**DAEWOO Lacetti**, 5-dr Hatchback, 04–  
**DAEWOO Lacetti**, 4-dr Sedan, 04–  
**DAEWOO Nubira III**, 4-dr Sedan, 04–  
**HOLDEN Viva**, 5-dr Hatchback, 04–  
**HOLDEN Viva**, 4-dr Sedan, 04–

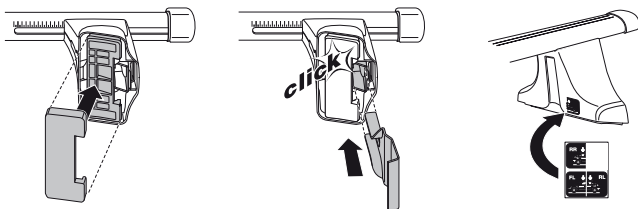
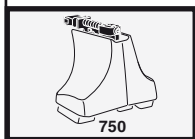
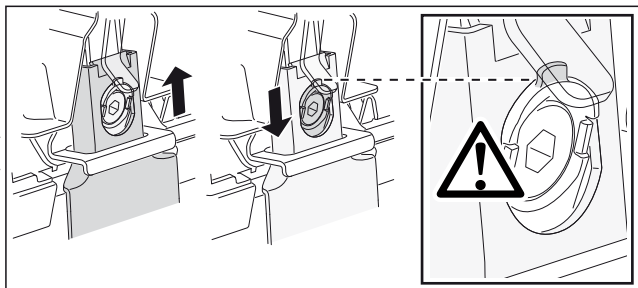
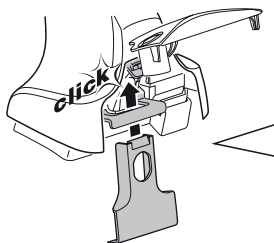
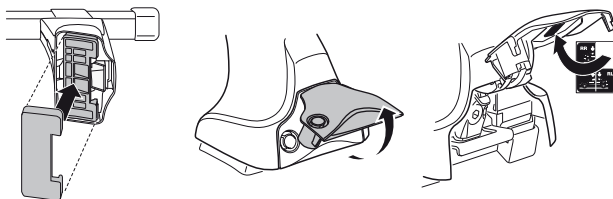
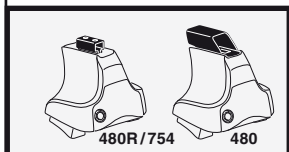
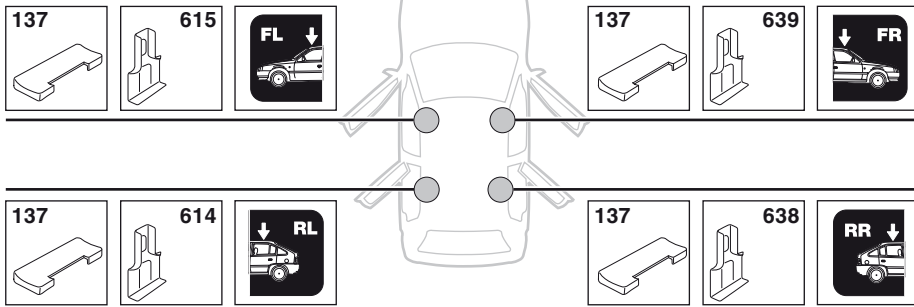

5

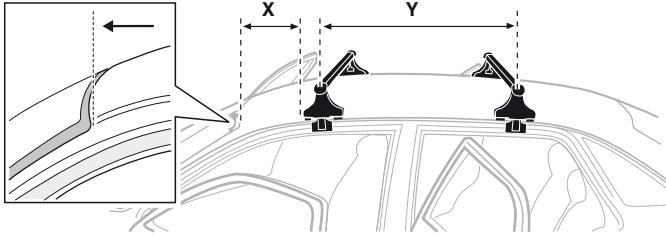
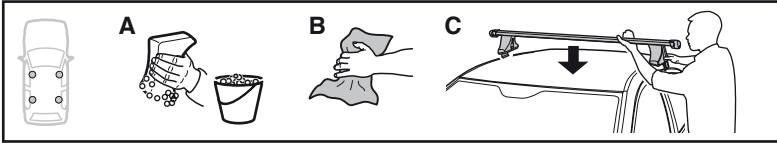

	X mm	Y mm	X inch	Y inch
<b>BUICK Excelle</b> , 5-dr Hatchback, 04–	250 mm	650 mm	9 7/8" "	25 5/8" "
<b>BUICK Excelle</b> , 4-dr Sedan, 04–	250 mm	650 mm	9 7/8" "	25 5/8" "
<b>CHEVROLET Lacetti</b> , 5-dr Hatchback, 04–	250 mm	650 mm	9 7/8" "	25 5/8" "
<b>CHEVROLET Nubira III</b> , 4-dr Sedan, 04–	250 mm	650 mm	9 7/8" "	25 5/8" "
<b>CHEVROLET Optra</b> , 5-dr Hatchback, 04–	250 mm	650 mm	9 7/8" "	25 5/8" "
<b>CHEVROLET Optra</b> , 4-dr Sedan, 04–	250 mm	650 mm	9 7/8" "	25 5/8" "
<b>DAEWOO Lacetti</b> , 5-dr Hatchback, 04–	250 mm	650 mm	9 7/8" "	25 5/8" "
<b>DAEWOO Lacetti</b> , 4-dr Sedan, 04–	250 mm	650 mm	9 7/8" "	25 5/8" "
<b>DAEWOO Nubira III</b> , 4-dr Sedan, 04–	250 mm	650 mm	9 7/8" "	25 5/8" "
<b>HOLDEN Viva</b> , 5-dr Hatchback, 04–	250 mm	650 mm	9 7/8" "	25 5/8" "
<b>HOLDEN Viva</b> , 4-dr Sedan, 04–	250 mm	650 mm	9 7/8" "	25 5/8" "

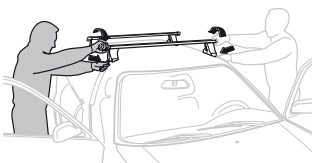
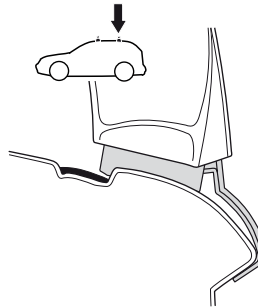
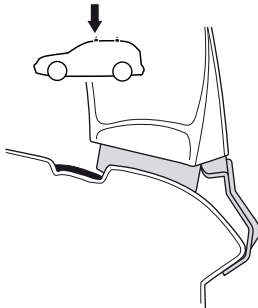

GB/US

Tighten alternately

D Die Schrauben abwechselnd anziehen

F Serrer alternativement chaque côté

NL Afwisselend aan de linker- en de rechterkant aandraaien

I Alternare il serraggio delle viti

E Apretar alternativamente

PT Aperte alternadamente

S Dra åt växelvis

FIN Kierrä vuorotellen

EST Pinguldage vaheldumisi

LAT Pielvelciet pamišus

LIT Užsukinėkite pakaitomis

PL Śruby dokręcaj naprzemiennie

RU Затягивайте попеременно

CZ

Pokrétla багаžníka dokręcaj dokręcaj naprzemiennie.

SK

Dofahujtie striedavo

SLO

Privijaite izmenično.

HR

Naizmjenično zategnite

HU

Egymástól függetlenül szorítandó

GR

Σφιγγετε εναλλάξ

TR

Dönüşümlü sıkın

中文

交替拧紧

한국어

번갈아 가며 조이십시오.

日本語

交互に締め付けてください。

ไทย

ขันน๊อตสลับ



6



480R/754



480

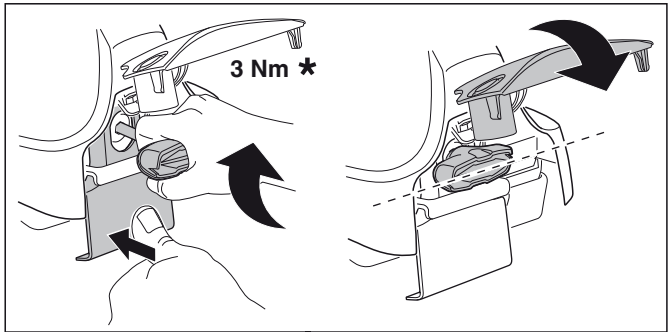
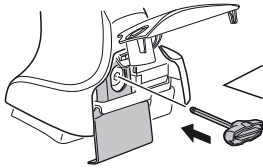

3 Nm \*

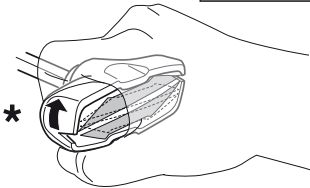

\*

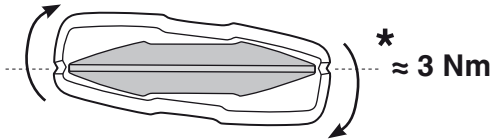

\* ≈ 3 Nm



750

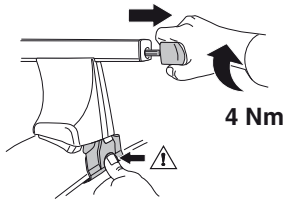

4 Nm

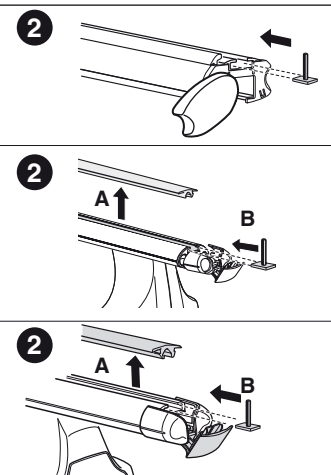
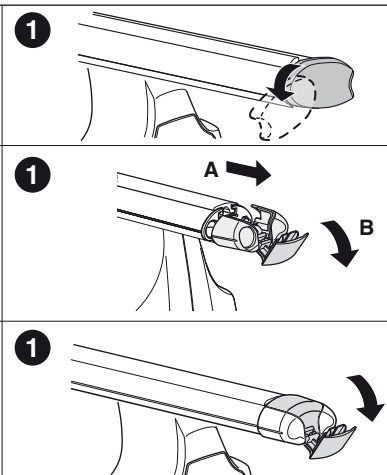
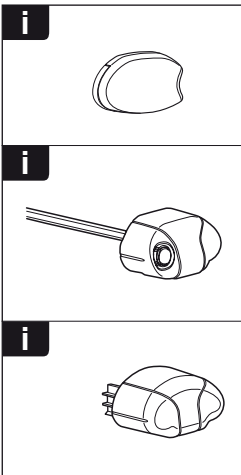
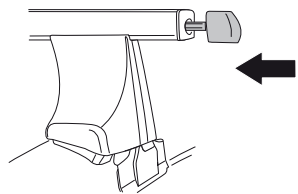





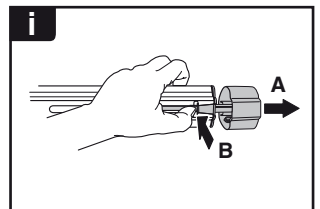
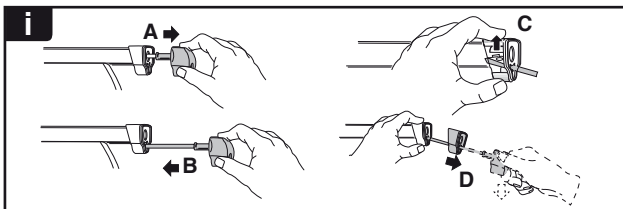
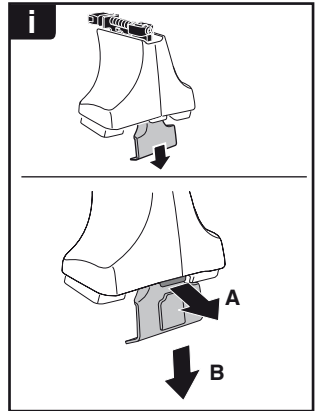
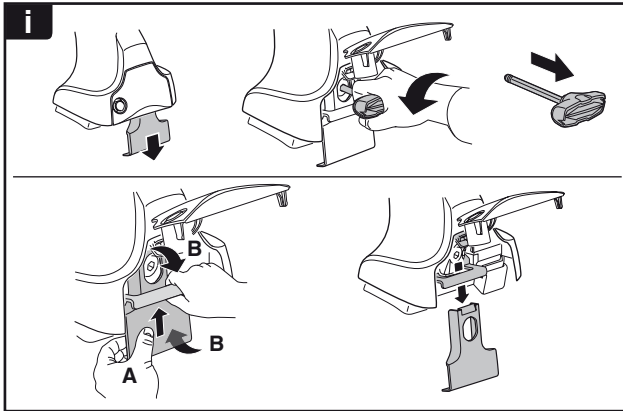
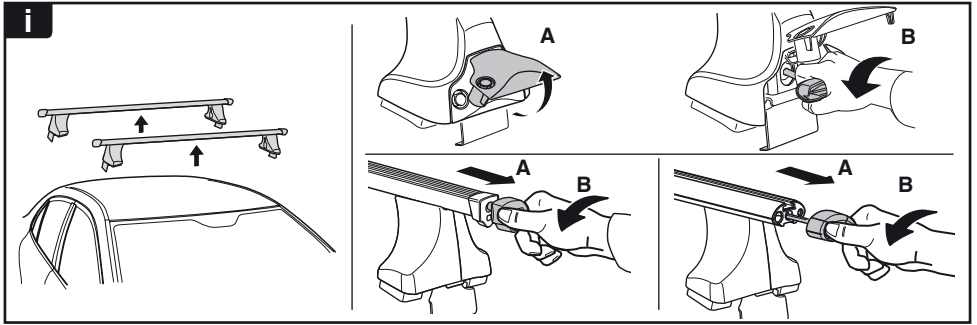

**THULE**  
SWEDEN  
**ONE  
KEY  
SYSTEM**

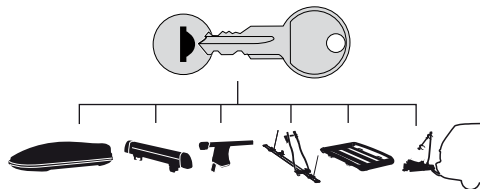

		544	(x4)
		596	(x6)
		588	(x8)
NA		510	(x10)
EUR		452	(x12)
ASIA			

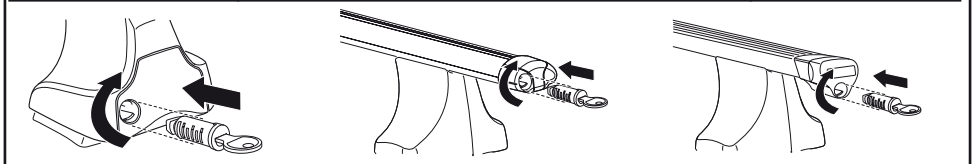

WW ▶ Thule Sweden AB, Box 69, 330 33 Hillerstorp, SWEDEN  
NA ▶ Thule Inc., 42 Silvermine Road, Seymour, Connecticut 06483, USA

info@thule.com  
customer.service@thule.com

www.thule.com