

# Kit 1312

HONDA Fit, 5-dr Hatchback, 02-04, 05-07 / \*07-08

HONDA Jazz, 5-dr Hatchback, 02-04, 05-08

\*North America

480R  
754

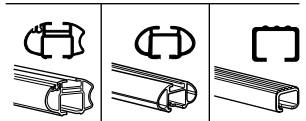
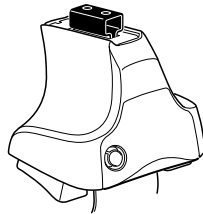

480

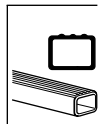
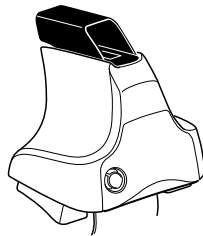

750

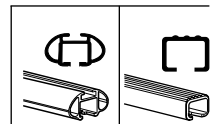
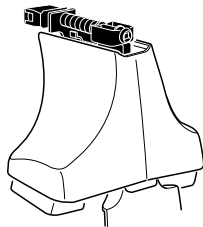

x2 x2 x2 x4	x2	x2 x2 x4 x4	x2 x2	x2

**560** x 4

**06** x 2

**31** x 1

**37** x 1

x 1

**Kit**

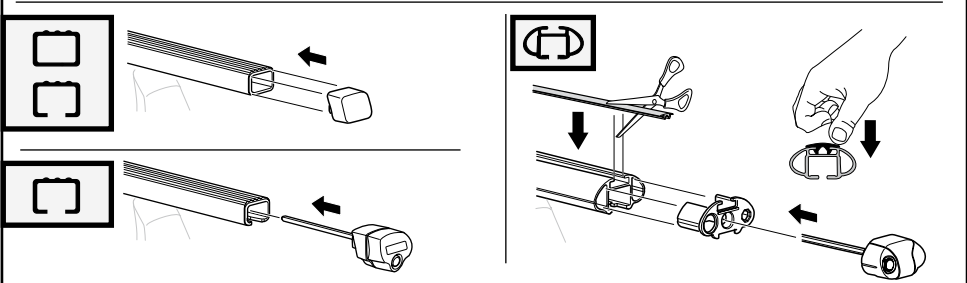
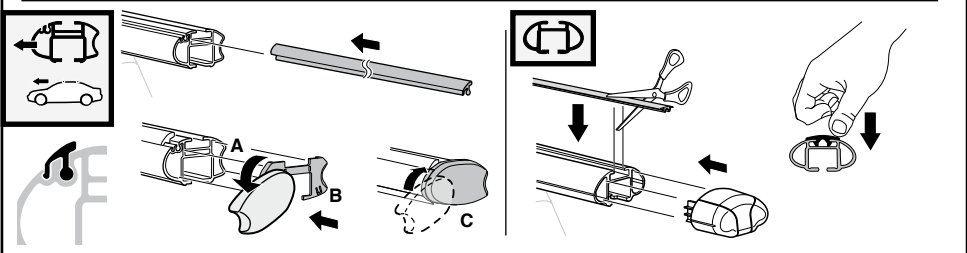
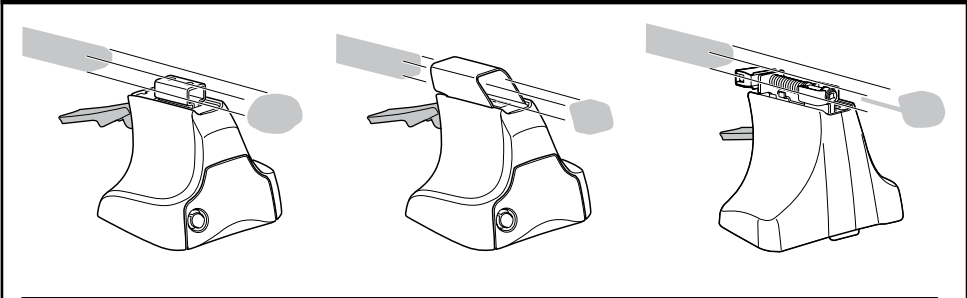
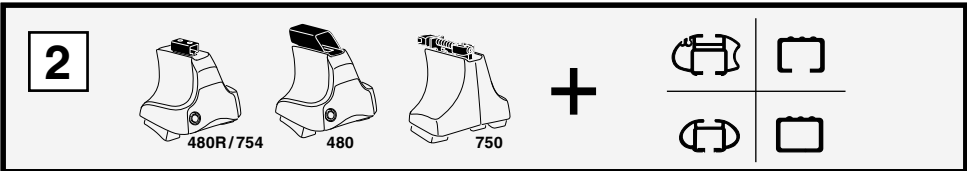
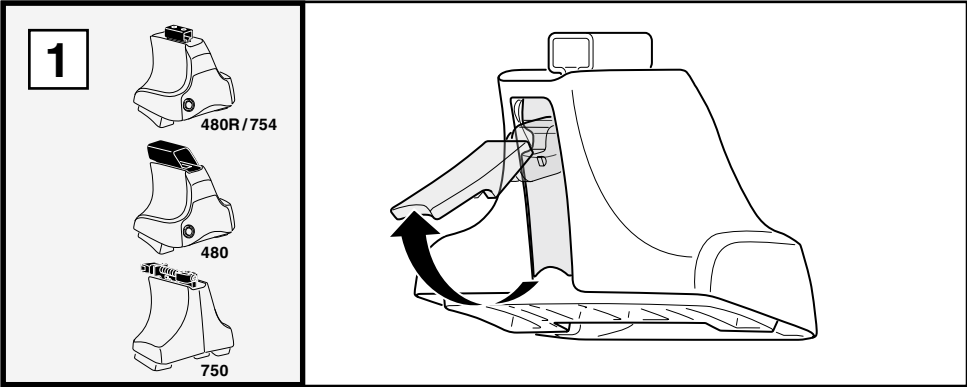

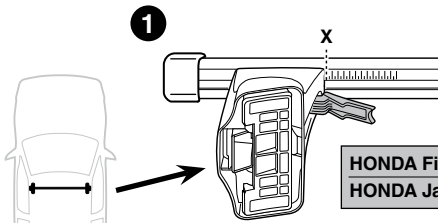
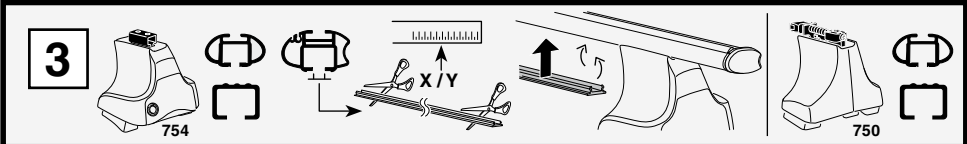

	X
HONDA Fit, 5-dr Hatchback, 02-04, 05-07 / *07-08	30,5
HONDA Jazz, 5-dr Hatchback, 02-04, 05-08	30,5

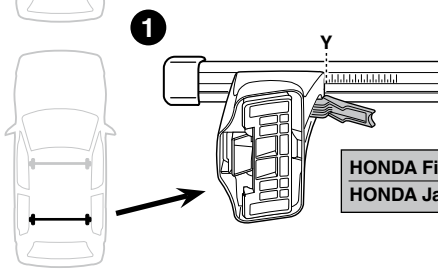

	Y
HONDA Fit, 5-dr Hatchback, 02-04, 05-07 / *07-08	26,5
HONDA Jazz, 5-dr Hatchback, 02-04, 05-08	26,5

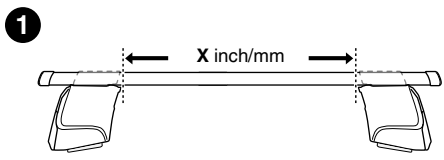
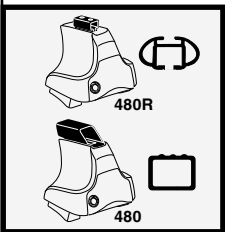

	X inch	X mm
HONDA Fit, 5-dr Hatchback, 02-04, 05-07 / *07-08	37 <sup>5</sup> / <sub>8</sub> "	956 mm
HONDA Jazz, 5-dr Hatchback, 02-04, 05-08	37 <sup>5</sup> / <sub>8</sub> "	956 mm

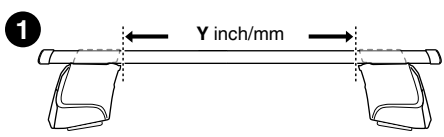
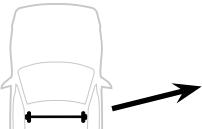
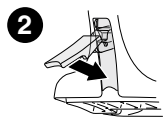

	Y inch	Y mm
HONDA Fit, 5-dr Hatchback, 02-04, 05-07 / *07-08	36 <sup>1</sup> / <sub>8</sub> "	916 mm
HONDA Jazz, 5-dr Hatchback, 02-04, 05-08	36 <sup>1</sup> / <sub>8</sub> "	916 mm

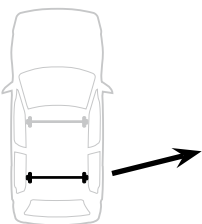

# 4

HONDA Fit, 5-dr Hatchback, 02-04, 05-07 / \*07-08

HONDA Jazz, 5-dr Hatchback, 02-04, 05-08

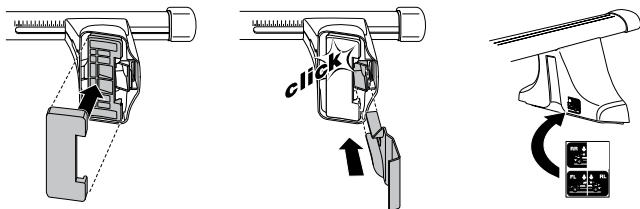
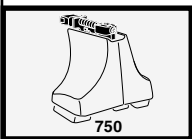
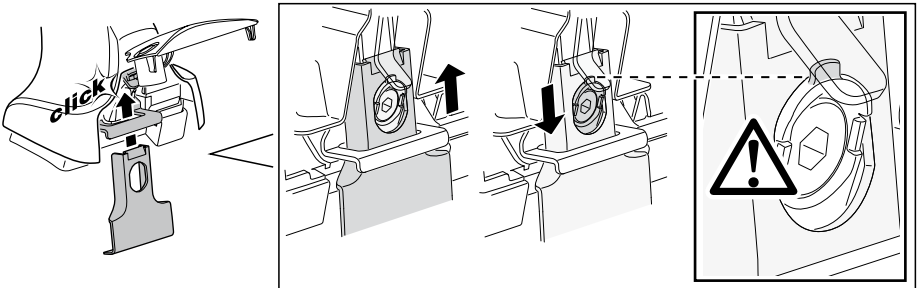
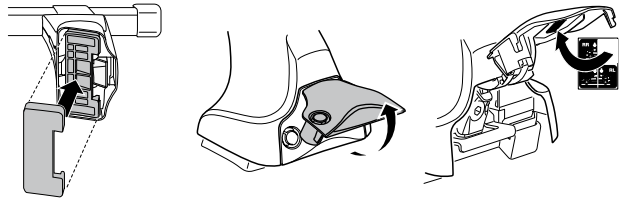
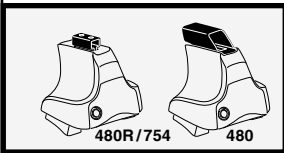
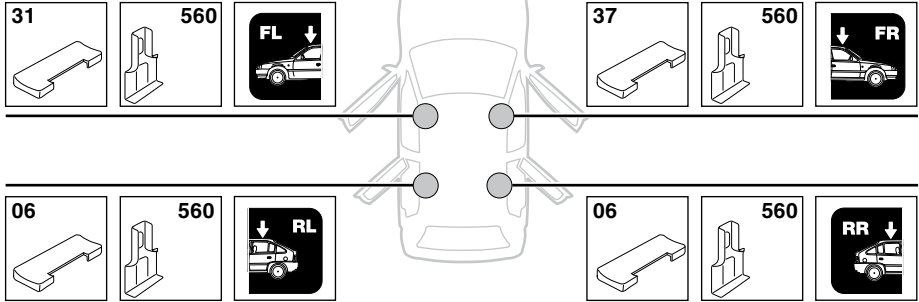

5



	X mm	Y mm	X inch	Y inch
HONDA Fit, 5-dr Hatchback, 02-04, 05-07 / *07-08	300 mm	700 mm	11 3/4"	27 1/4"
HONDA Jazz, 5-dr Hatchback, 02-04, 05-08	300 mm	700 mm	11 3/4"	27 1/4"

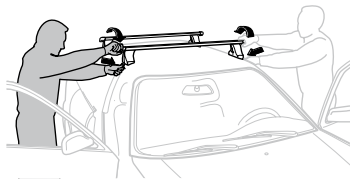
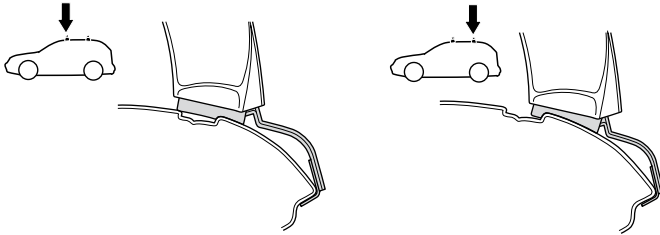
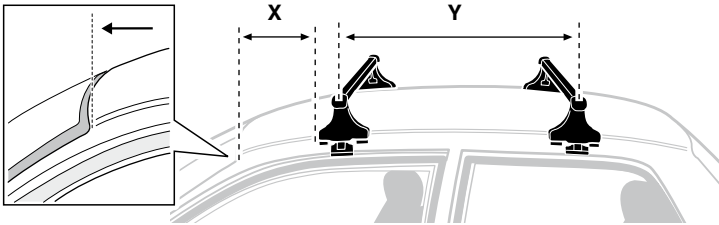

**GB/US** Tighten alternately

**D** Die Schrauben abwechselnd anziehen

**F** Serrer alternativement chaque côté

**NL** Afwisselend aan de linker- en de rechterkant aandraaien

**I** Alternare il serraggio delle viti

**E** Serrare alternativamente

**PT** Aperte alternadamente

**S** Dra åt växelvis

**FIN** Kierrä vuorotellen

**EST** Pinguldage vaheldumisi

**LAT** Pielieciet pamišus

**LIT** Užsukinėkite pakaitomis

**PL** Śruby dokręcaj naprzemiennie

**RU** Затягивайте попеременно

**CZ** Pokręťta bagažníka dokręcaj dokręcaj naprzemiennie.

**SK** Doťahujte striedavo

**SLO** Privijajte izmenično.

**HR** Naizmjenično zategnite

**HU** Egymástól függetlenül szorítandó

**GR** Σφιγγετε εναλλάξ

**TR** Dönüşümlü sıkın

**中文** 交替拧紧

**한국어** 번갈아 가며 조이십시오.

**日本語** 交互に締め付けてください。

**ไทย** ชั้้นในแบบสลับ

6



480R/754



480

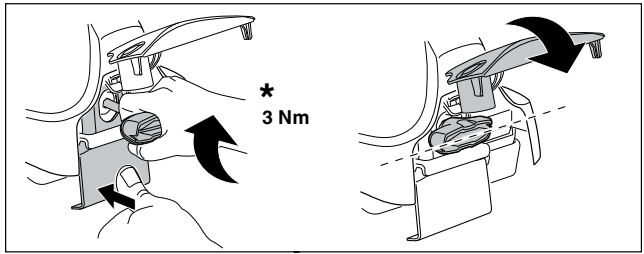
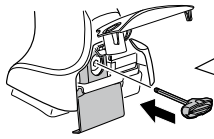

\*  
3 Nm



\*

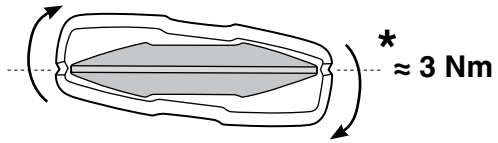

\*  
≈ 3 Nm

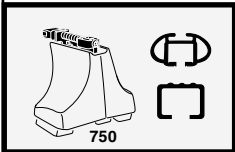
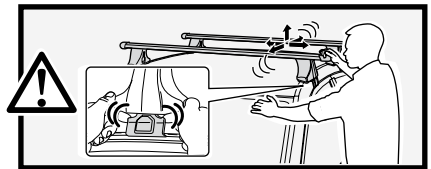

750

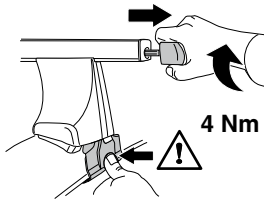

4 Nm

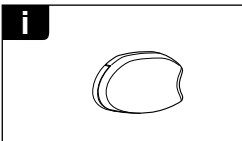
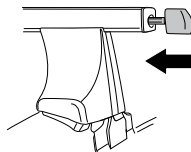

i

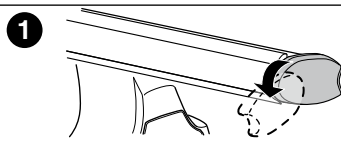

1

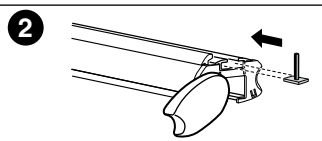

2

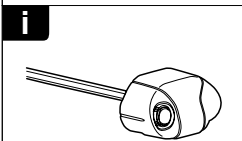

i

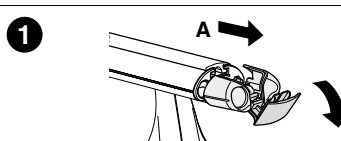

1

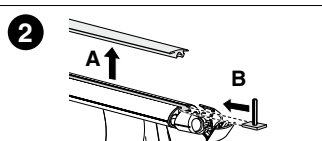

2

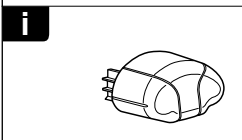

i

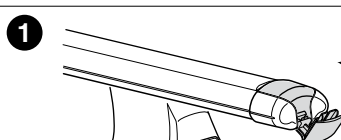

1

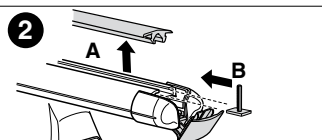

2



**THULE**  
SWEDEN  
**ONE  
KEY  
SYSTEM**



		(x4)
		(x6)
		(x8)
NA		(x10)
EUR		(x12)
ASIA		(x12)



WW ▶ Thule Sweden AB, Box 69, 330 33 Hillerstorp, SWEDEN  
NA ▶ Thule Inc., 42 Silvermine Road, Seymour, Connecticut 06483, USA

info@thule.com  
customer.service@thule.com

www.thule.com

503-1312-02