

Kit 1301

OPEL Meriva, 5-dr MPV, 03-09

VAUXHALL Meriva, 5-dr MPV, 03-09

480R
754

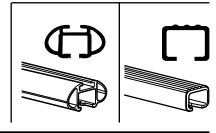
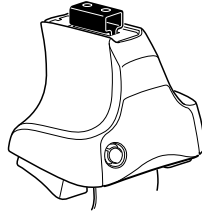

480

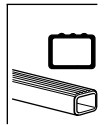
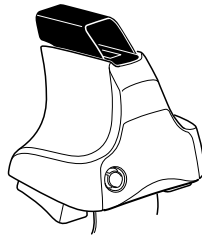

750

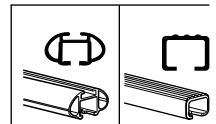
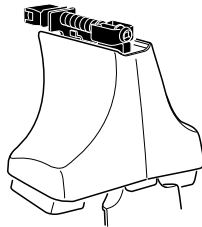

THULE[®]
SWEDEN

Kit

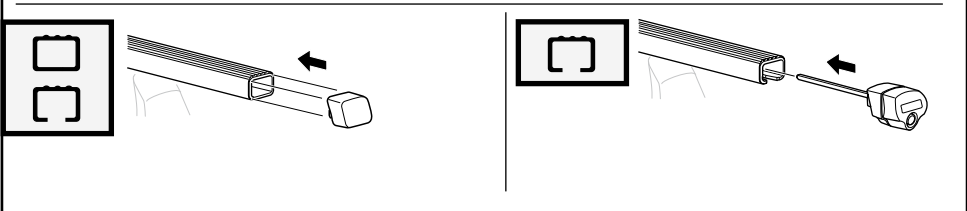
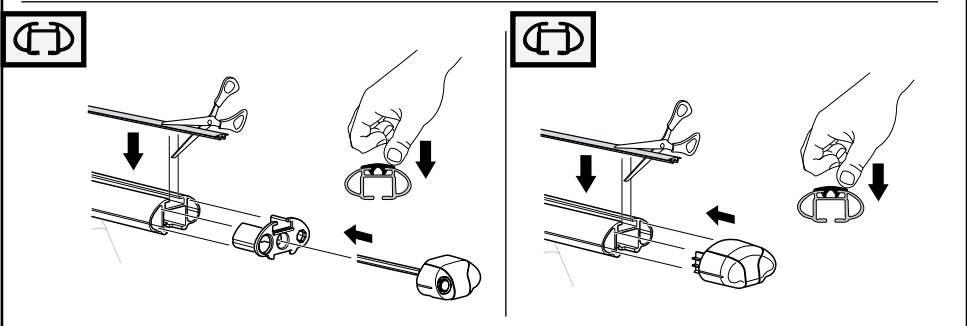
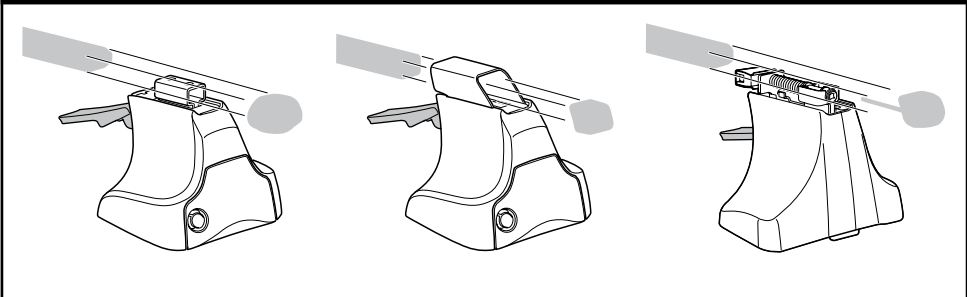
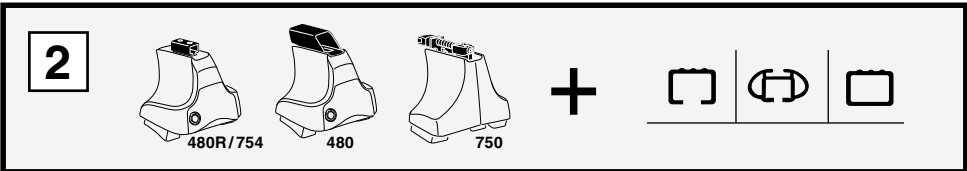
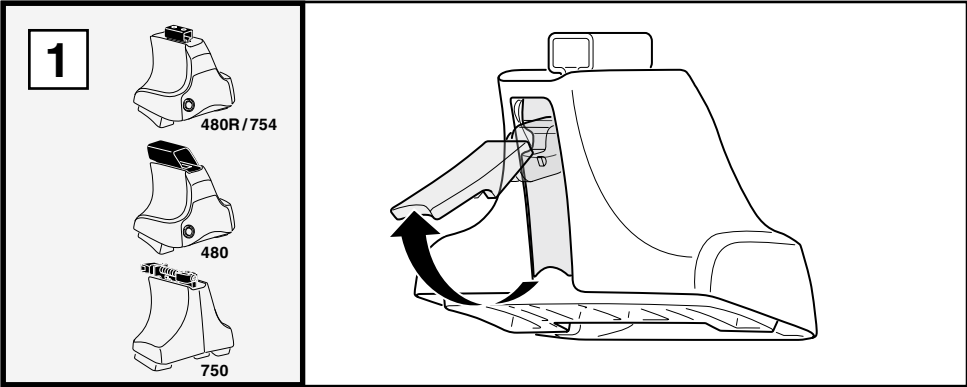

3

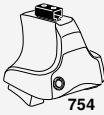

754

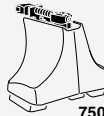

750



1

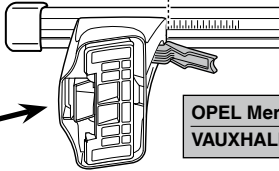
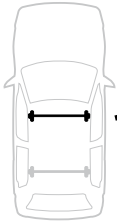

2

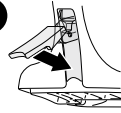

X

OPEL Meriva, 5-dr MPV, 03-09	38,5
VAUXHALL Meriva, 5-dr MPV, 03-09	38,5

1

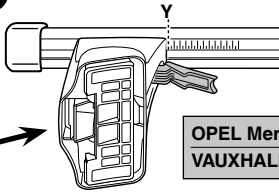
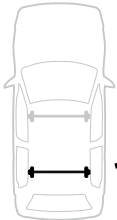

2

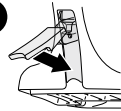

Y

OPEL Meriva, 5-dr MPV, 03-09	32,5
VAUXHALL Meriva, 5-dr MPV, 03-09	32,5



480R



480

1

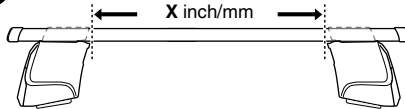

2

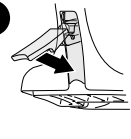

X inch X mm

OPEL Meriva, 5-dr MPV, 03-09	40 ³/₄ "	1036 mm
VAUXHALL Meriva, 5-dr MPV, 03-09	40 ³/₄ "	1036 mm

1

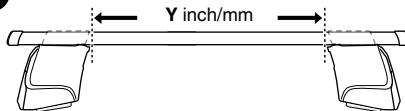

2

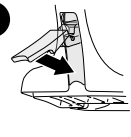

Y inch Y mm

OPEL Meriva, 5-dr MPV, 03-09	38 ³/₈ "	976 mm
VAUXHALL Meriva, 5-dr MPV, 03-09	38 ³/₈ "	976 mm

4

OPEL Meriva, 5-dr MPV, 03-09
VAUXHALL Meriva, 5-dr MPV, 03-09

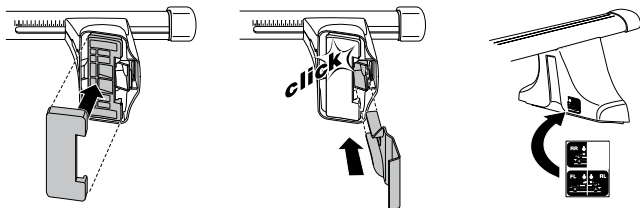
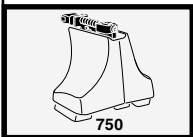
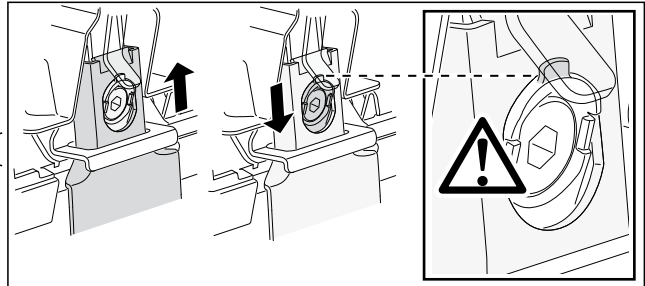
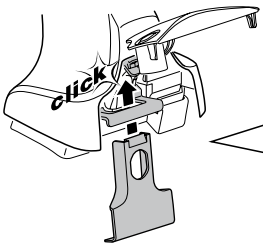
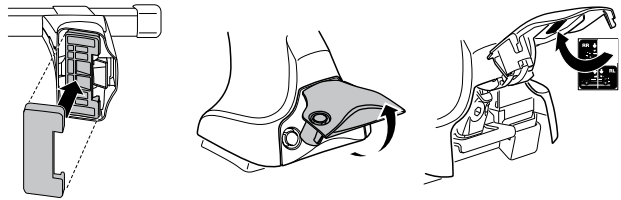
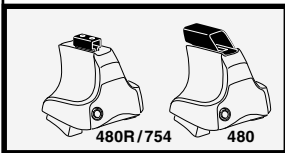
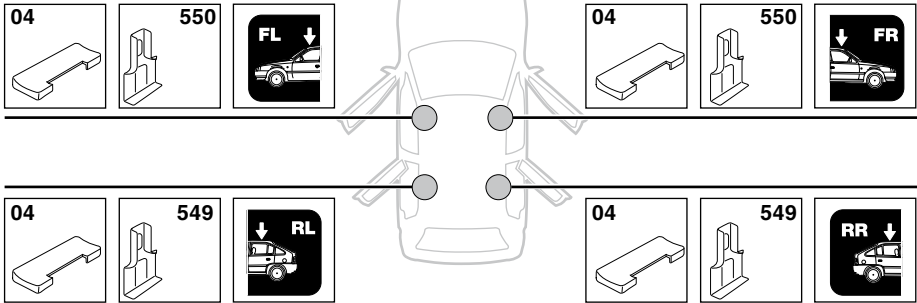

5

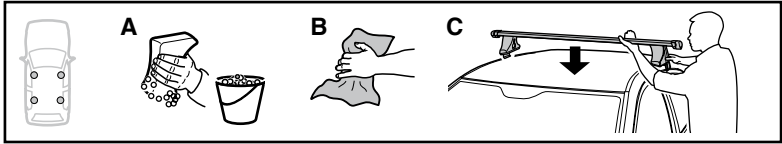

	X mm	Y mm	X inch	Y inch
OPEL Meriva, 5-dr MPV, 03-09	250 mm	700 mm	9 7/8"	27 1/2"
VAUXHALL Meriva, 5-dr MPV, 03-09	250 mm	700 mm	9 7/8"	27 1/2"

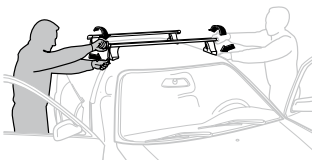
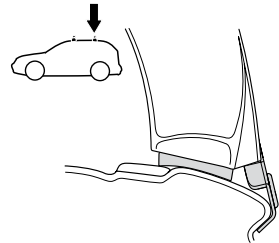
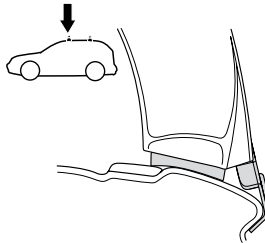
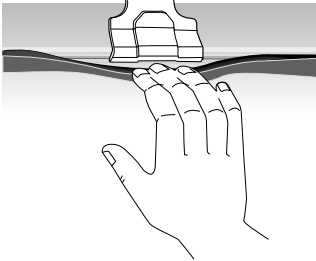
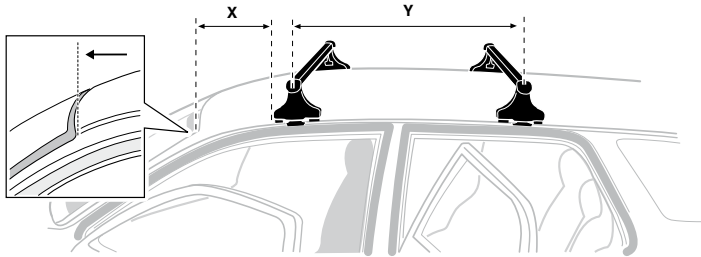

- | | | | |
|--------------|---|------------|--|
| GB/US | Tighten alternately | CZ | Pokrétla bagazníka dokrečej naprzemiennie. |
| D | Die Schrauben abwechselnd anziehen | SK | Dotahujte striedavo. |
| F | Serrer alternativement chaque côté | SLO | Privijajte izmenično. |
| NL | Afwisselend aan de linker- en de rechterkant aandraaien | HR | Naizmjenično zategnite |
| I | Alternare il serraggio delle viti | HU | Egymástól függetlenül szorítandó |
| E | Apretar alternativamente | GR | Σφιγίγεται εναλλάξ |
| PT | Aperte alternadamente | TR | Dönüşümlü sıkın |
| S | Dra åt växelvis | 中文 | 交替拧紧 |
| FIN | Kierrä vuorotellen | 한국어 | 번갈아가며 조이십시오. |
| EST | Pinguldage vaheldumisi | 日本語 | 交互に締め付けてください。 |
| LAT | Pievelciot pamišus | ไทย | ขันในแบบสลับ |
| LIT | Užsukinėkite pakaitomis | | |
| PL | Śruby dokrečej naprzemiennie | | |
| RU | Затягивайте попеременно | | |

6

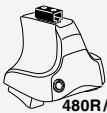

480R/754



480

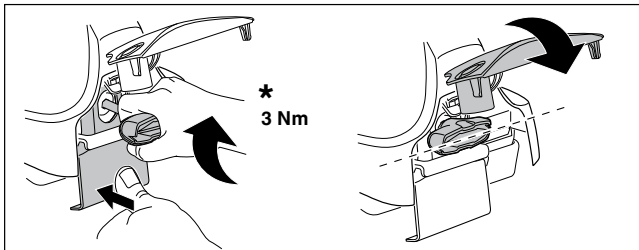
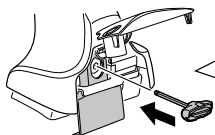

*
3 Nm

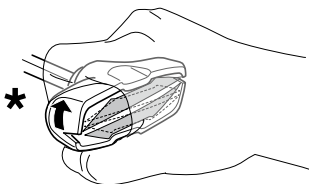

*

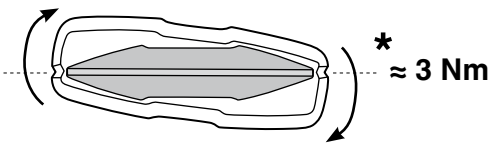

*
≈ 3 Nm

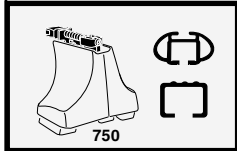
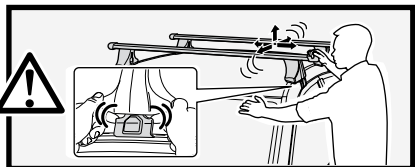

750

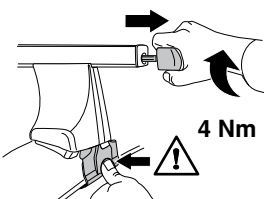

4 Nm

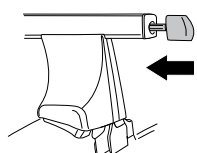

7

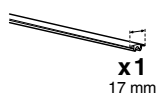

x1
17 mm

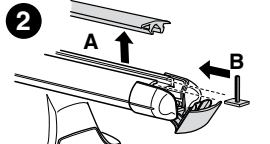
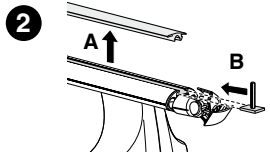
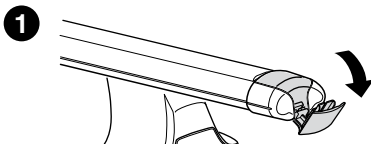
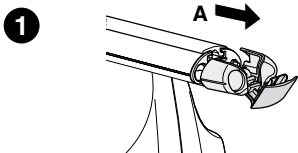
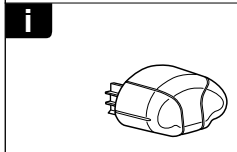
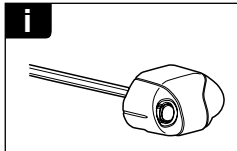
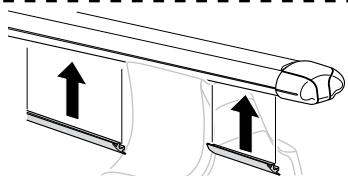

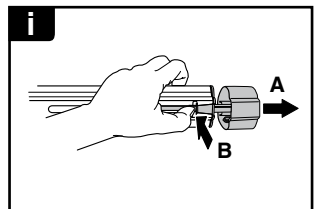
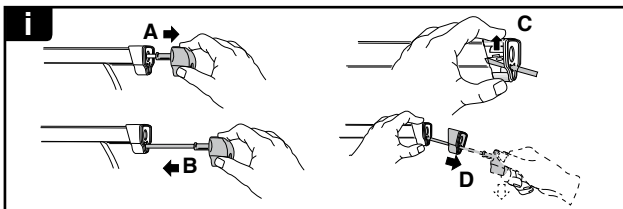
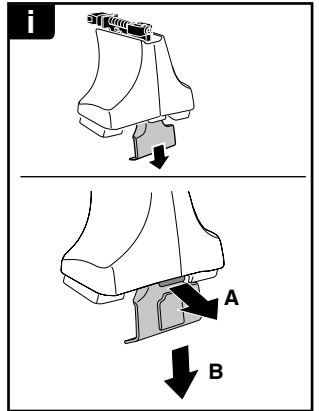
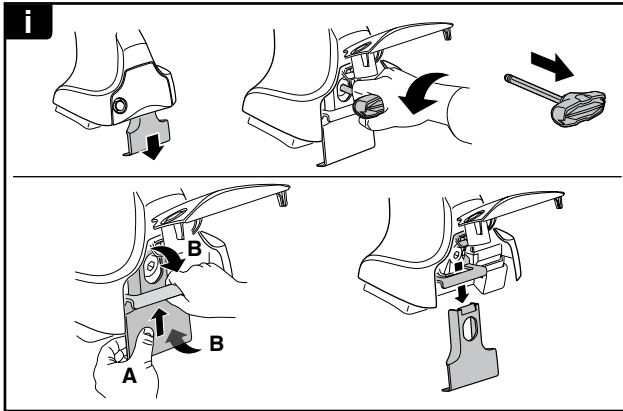
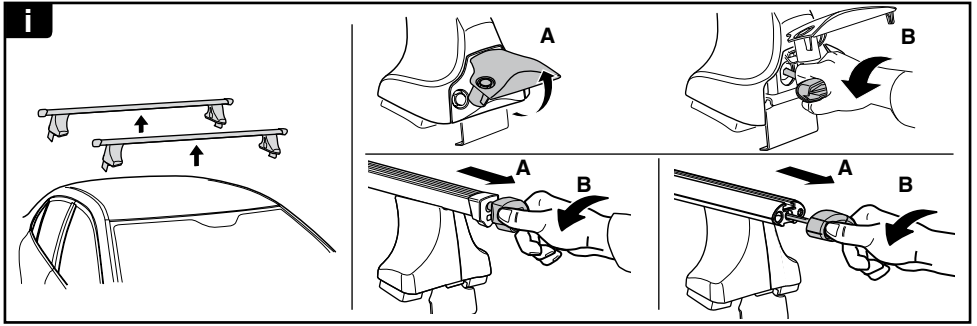

THULE
SWEDEN
**ONE
KEY
SYSTEM**

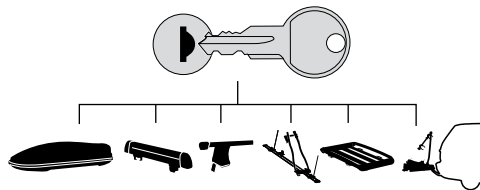

		(x4)
		(x6)
		(x8)
NA		(x10)
EUR		(x12)
ASIA		

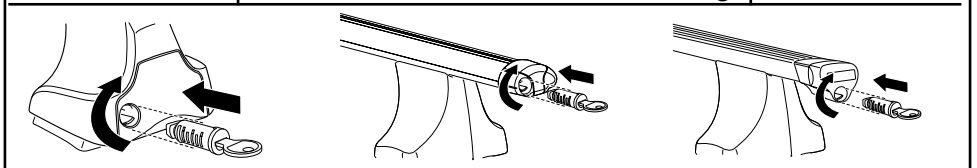

WW ▶ Thule Sweden AB, Box 69, 330 33 Hillerstorp, SWEDEN
NA ▶ Thule Inc., 42 Silvermine Road, Seymour, Connecticut 06483, USA

info@thule.com
customer.service@thule.com

www.thule.com