

Kit 1207

CHEVROLET Rezzo, 5-dr Estate, 00-04, 05-08

DAEWOO Tacuma, 5-dr Estate, 00-04, 05-08

DAEWOO Rezzo, 5-dr Estate, 00-04, 05-08

480R
754

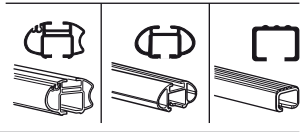
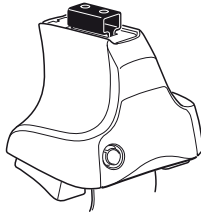

480

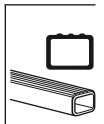
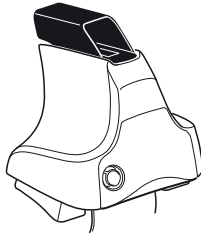

750

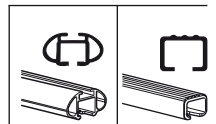
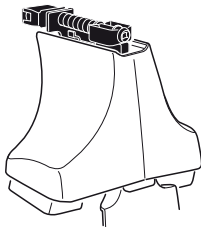

Max. 75kg
Max. 165 lbs

Kit XXXX
 instructions

x1

x4

x4

x4
 x4

480R/754

x1

x4

x4

x4

480

x1

x4

x4

750

x2 x2 x2 x4	x2	x2 x2 x4 x4	x2 x2	x2
----------------------	----	----------------------	----------	----

146 x 2

365 x 2

06 x 2

15 x 2

x 1

Kit

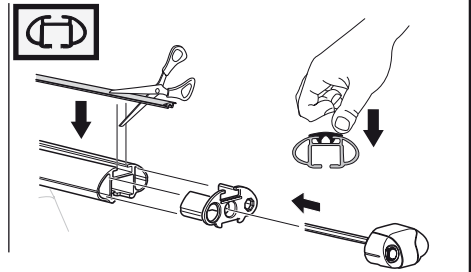
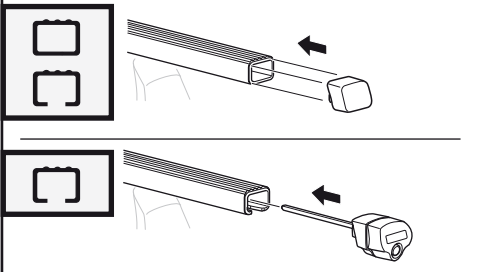
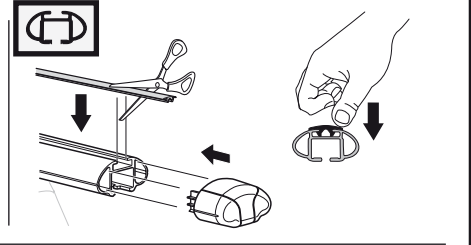
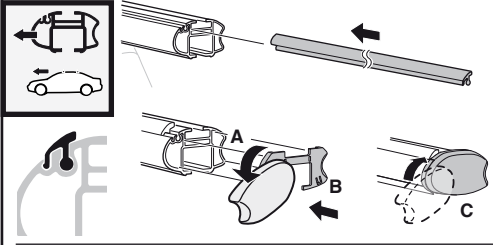
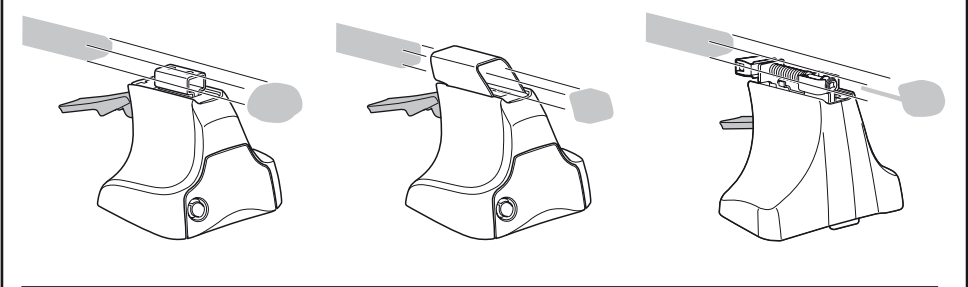
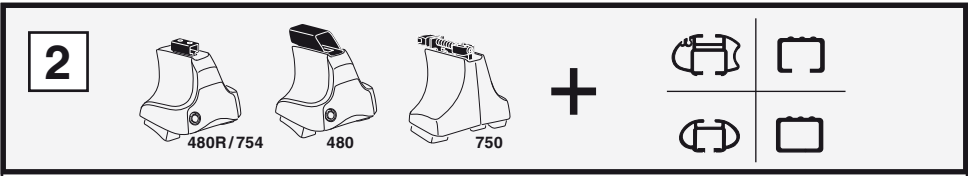
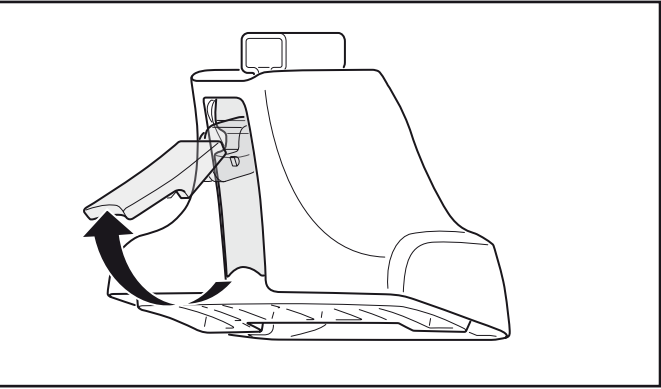
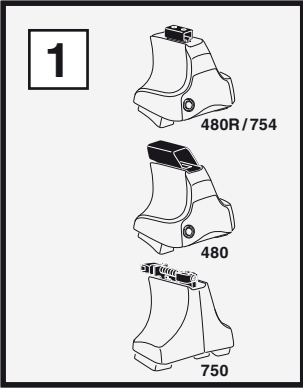

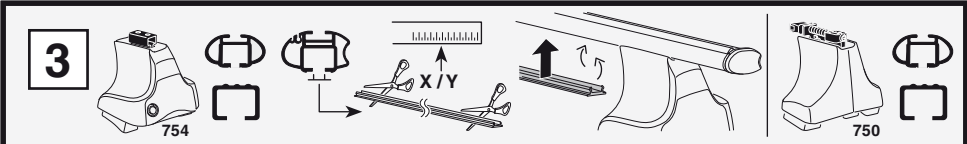

1

2

	X
CHEVROLET Rezzo, 5-dr Estate, 00-04, 05-08	40,5
DAEWOO Tacuma, 5-dr Estate, 00-04, 05-08	40,5
DAEWOO Rezzo, 5-dr Estate, 00-04, 05-08	40,5

1

2

	Y
CHEVROLET Rezzo, 5-dr Estate, 00-04, 05-08	36
DAEWOO Tacuma, 5-dr Estate, 00-04, 05-08	36
DAEWOO Rezzo, 5-dr Estate, 00-04, 05-08	36

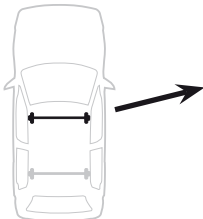
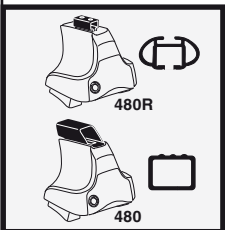

1

2

	X inch	X mm
CHEVROLET Rezzo, 5-dr Estate, 00-04, 05-08	41 ⁵/₈ "	1056 mm
DAEWOO Tacuma, 5-dr Estate, 00-04, 05-08	41 ⁵/₈ "	1056 mm
DAEWOO Rezzo, 5-dr Estate, 00-04, 05-08	41 ⁵/₈ "	1056 mm

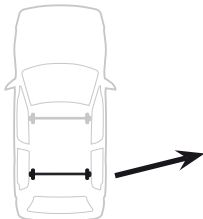

1

2

	Y inch	Y mm
CHEVROLET Rezzo, 5-dr Estate, 00-04, 05-08	39 ³/₄ "	1011 mm
DAEWOO Tacuma, 5-dr Estate, 00-04, 05-08	39 ³/₄ "	1011 mm
DAEWOO Rezzo, 5-dr Estate, 00-04, 05-08	39 ³/₄ "	1011 mm

4

CHEVROLET Rezzo, 5-dr Estate, 00-04, 05-08
 DAEWOO Tacuma, 5-dr Estate, 00-04, 05-08
 DAEWOO Rezzo, 5-dr Estate, 00-04, 05-08

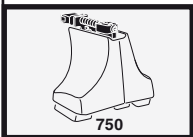
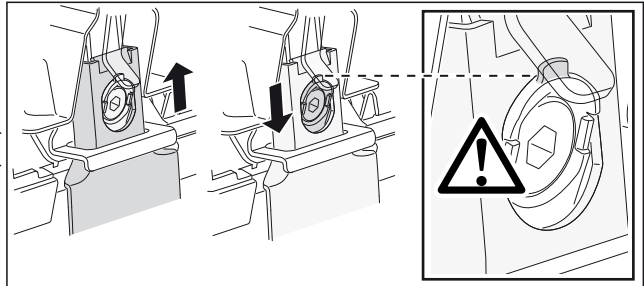
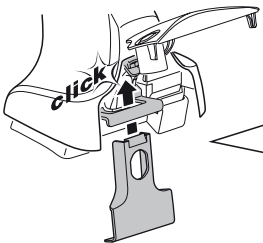
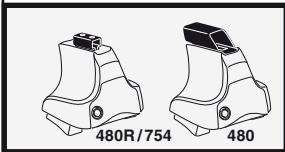
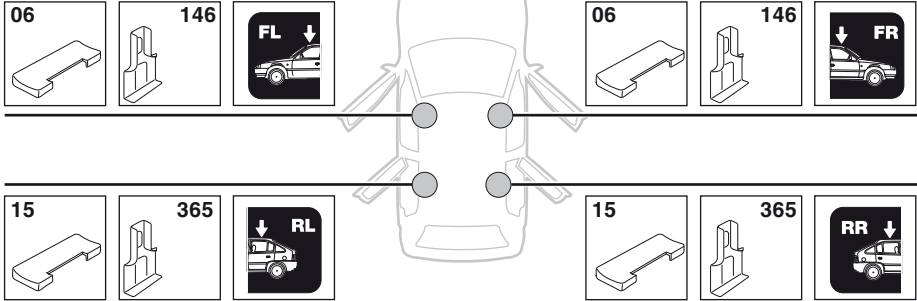

5



	X mm	Y mm	X inch	Y inch
CHEVROLET Rezzo, 5-dr Estate, 00-04, 05-08	350 mm	700 mm	13 3/4"	27 1/2"
DAEWOO Tacuma, 5-dr Estate, 00-04, 05-08	350 mm	700 mm	13 3/4"	27 1/2"
DAEWOO Rezzo, 5-dr Estate, 00-04, 05-08	350 mm	700 mm	13 3/4"	27 1/2"

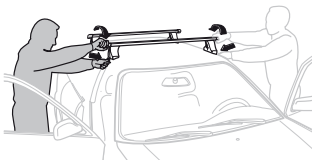
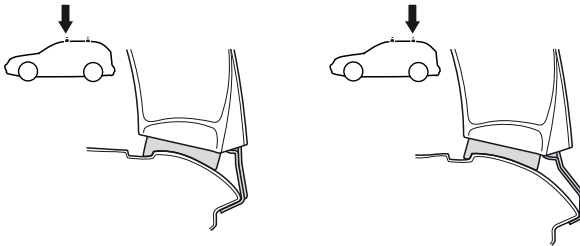
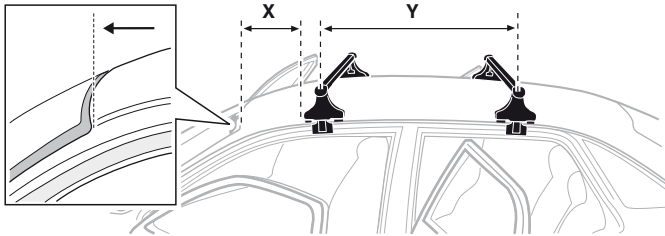

- | | | | |
|--------------|---|------------|--|
| GB/US | Tighten alternately | CZ | Pokřeřtla багажника докřeřcaj dokřeřcaj naprzemiennie. |
| D | Die Schrauben abwechselnd anziehen | SK | Dořahujte striedavo |
| F | Serrer alternativement chaque cōtē | SLO | Privijajte izmenično. |
| NL | Afwisselend aan de linker- en de rechterkant aandraaien | HR | Naizmjenično zategnite |
| I | Alternare il serraggio delle viti | HU | Egymástól függetlenül szorítandó |
| E | Apretar alternativamente | GR | Σφιγγετε εναλάξ |
| PT | Aperte alternadamente | TR | Dönüşümlü sıkın |
| S | Dra åt växelvis | 中文 | 交替拧紧 |
| FIN | Kierrä vuorotellen | 한국어 | 번갈아 가며 조이십시오. |
| EST | Pinguldage vaheldumisi | 日本語 | 交互に締め付けてください。 |
| LAT | Pievelciēt pamīšus | ไทย | ขันในแบบสลับ |
| LIT | Užsukinėkite pakaitomis | | |
| PL | Śruby dokřeřcaj naprzemiennie | | |
| RU | Затягивайте попеременно | | |

6



480R/754



480

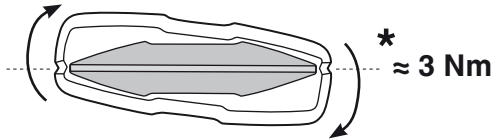
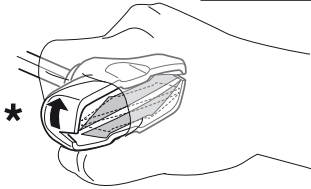
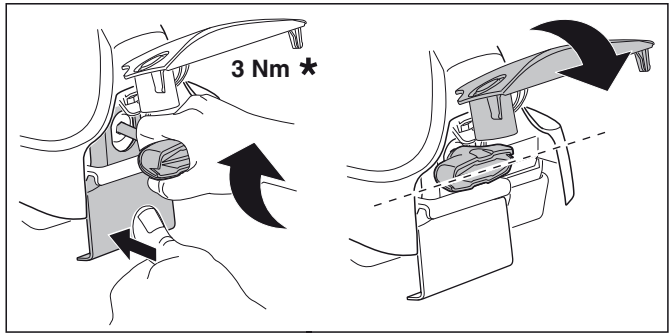

750

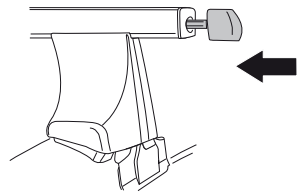
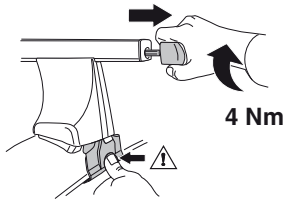

i



1



2

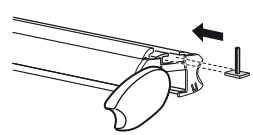

i

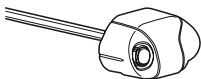

1

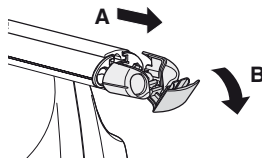

2

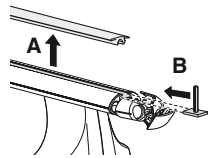

i



1

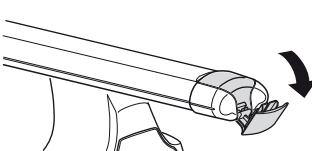

2

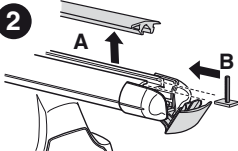



THULE
SWEDEN
**ONE
KEY
SYSTEM**



- 544 (x4)
- 596 (x6)
- 588 (x8)
- NA 510 (x10)
- EUR 452 (x12)
- ASIA 452 (x12)



WW ▶ Thule Sweden AB, Box 69, 330 33 Hillerstorp, SWEDEN
NA ▶ Thule Inc., 42 Silvermine Road, Seymour, Connecticut 06483, USA

info@thule.com
customer.service@thule.com

www.thule.com