

Kit 1105

DAEWOO d'Artz, 5-dr Hatchback, 98-00, 01-05

DAEWOO Matiz, 5-dr Hatchback, 98-00, 01-05

CHEVROLET Matiz, 5-dr Hatchback, 01-05

480R
754

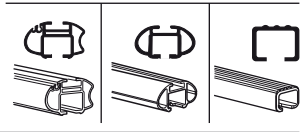
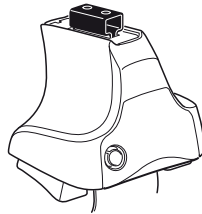

480

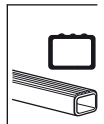
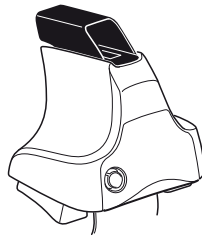

750

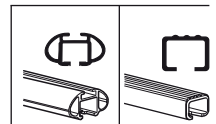
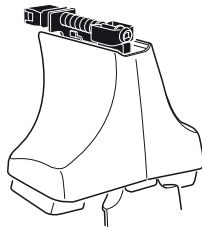

Kit



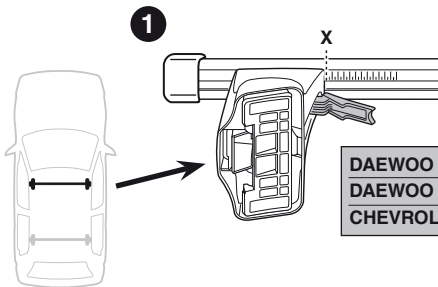
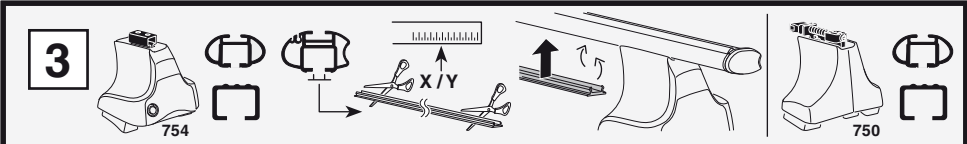

	X
DAEWOO d'Artz, 5-dr Hatchback, 98-00, 01-05	25
DAEWOO Matiz, 5-dr Hatchback, 98-00, 01-05	25
CHEVROLET Matiz, 5-dr Hatchback, 01-05	25

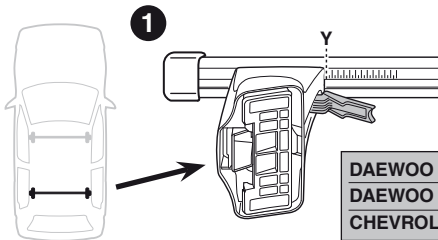

	Y
DAEWOO d'Artz, 5-dr Hatchback, 98-00, 01-05	24
DAEWOO Matiz, 5-dr Hatchback, 98-00, 01-05	24
CHEVROLET Matiz, 5-dr Hatchback, 01-05	24

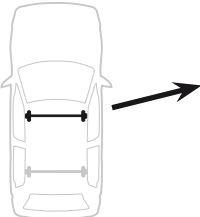
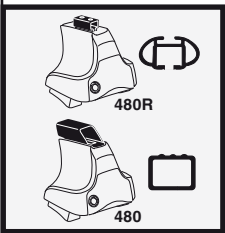

	X inch	X mm
DAEWOO d'Artz, 5-dr Hatchback, 98-00, 01-05	35 1/2"	901 mm
DAEWOO Matiz, 5-dr Hatchback, 98-00, 01-05	35 1/2"	901 mm
CHEVROLET Matiz, 5-dr Hatchback, 01-05	35 1/2"	901 mm

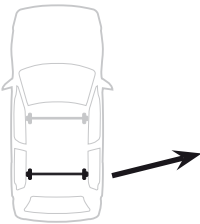
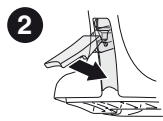

	Y inch	Y mm
DAEWOO d'Artz, 5-dr Hatchback, 98-00, 01-05	35 1/8"	891 mm
DAEWOO Matiz, 5-dr Hatchback, 98-00, 01-05	35 1/8"	891 mm
CHEVROLET Matiz, 5-dr Hatchback, 01-05	35 1/8"	891 mm



4

DAEWOO d'Artz, 5-dr Hatchback, 98-00, 01-05

DAEWOO Matiz, 5-dr Hatchback, 98-00, 01-05

CHEVROLET Matiz, 5-dr Hatchback, 01-05

07



66

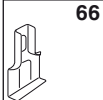

07

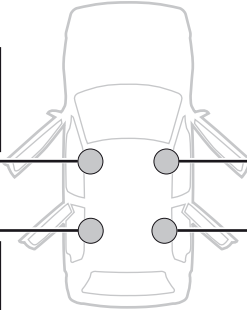
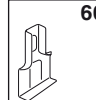
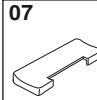

07



66

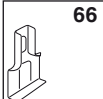

07

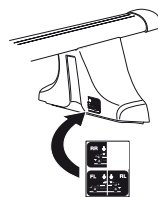
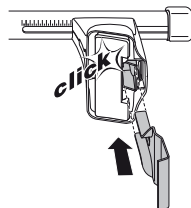
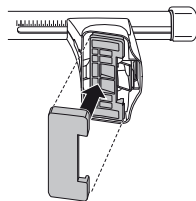
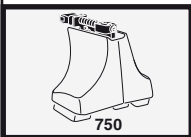
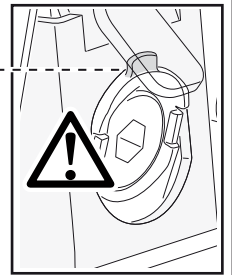
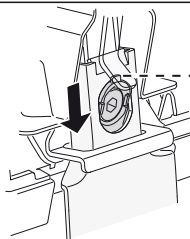
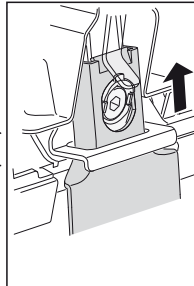
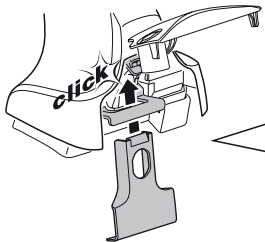
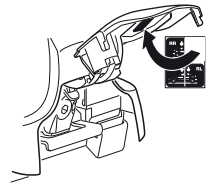
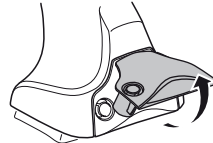
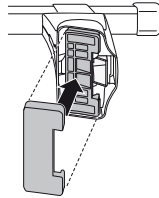
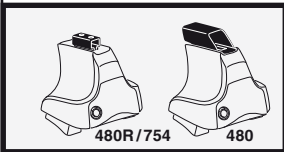

5



	X mm	Y mm	X inch	Y inch
DAEWOO d'Artz , 5-dr Hatchback, 98-00, 01-05	250 mm	700 mm	9 7/8"	27 1/2"
DAEWOO Matiz , 5-dr Hatchback, 98-00, 01-05	250 mm	700 mm	9 7/8"	27 1/2"
CHEVROLET Matiz , 5-dr Hatchback, 01-05	250 mm	700 mm	9 7/8"	27 1/2"

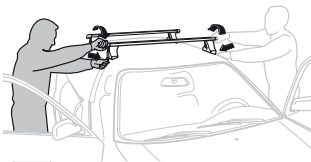
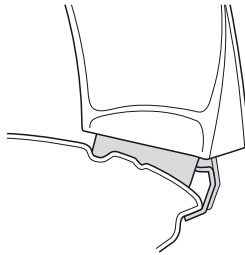
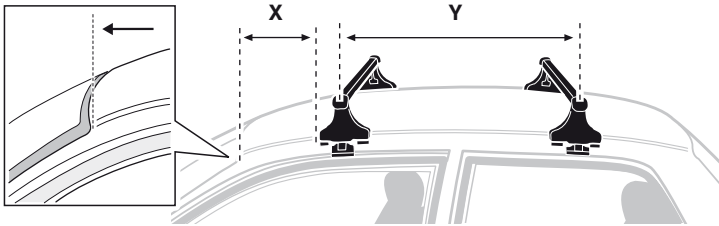

GB/US Tighten alternately
D Die Schrauben abwechselnd anziehen
F Serrer alternativement chaque côté
NL Afwisselend aan de linker- en de rechterkant aandraaien
I Alternare il serraggio delle viti
E Apretar alternativamente
PT Aperte alternadamente
S Dra åt växelvis
FIN Kierrä vuorotellen
EST Pinguldage vaheldumisi
LAT Pievelciēt pamīšus
LIT Užsukinėkite pakaitomis
PL Śruby dokręcaj naprzemiennie
RU Затягивайте попеременно

CZ Pokręťta багаžníka dokręcaj dokręcaj naprzemiennie.
SK Doťahujte striedavo
SLO Privijajte izmenično.
HR Naizmjenično zategnite
HU Egymástól függetlenül szorítandó
GR Σφιγγετε εναλλάξ
TR Dönüşümlü sıkın

中文 交替拧紧

한국어 번갈아 가며 조이십시오.

日本語 交互に締め付けてください。

ไทย ชั้้นในแบบสลับ

6



480R/754



480

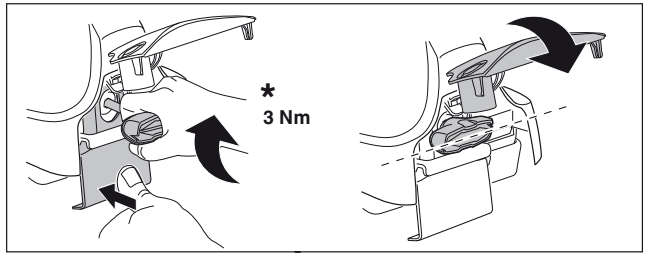
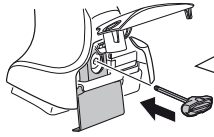

*
3 Nm



*

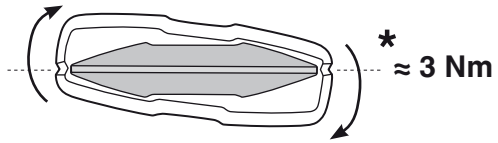

*
≈ 3 Nm

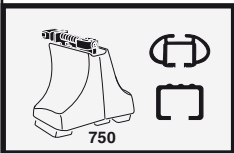
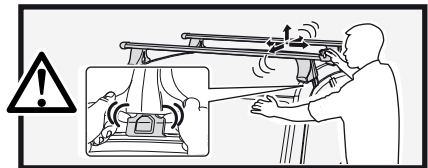

750

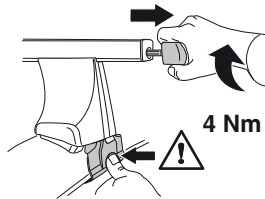

4 Nm

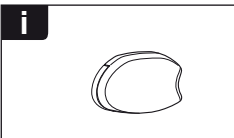
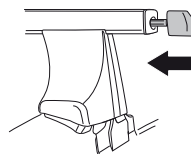

i

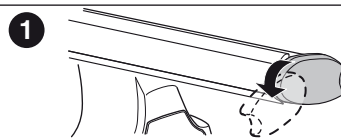

1

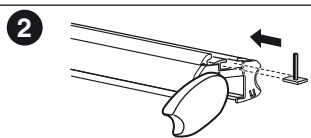

2

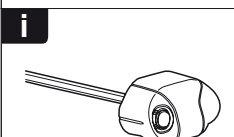

i

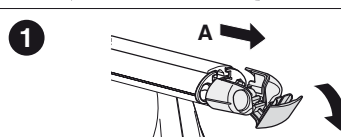

1

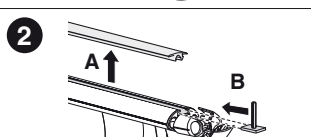

2

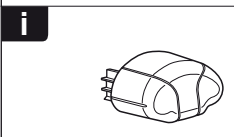

i

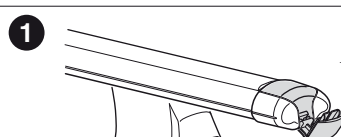

1

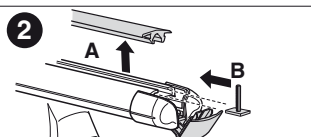

2

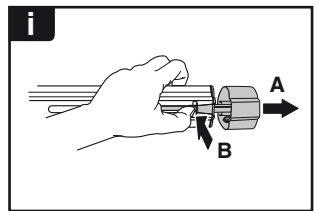
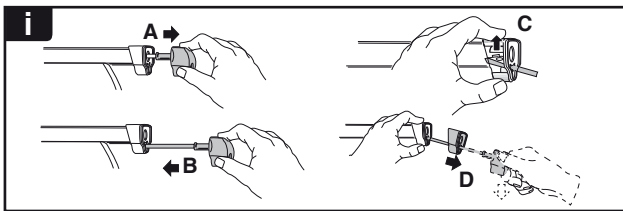
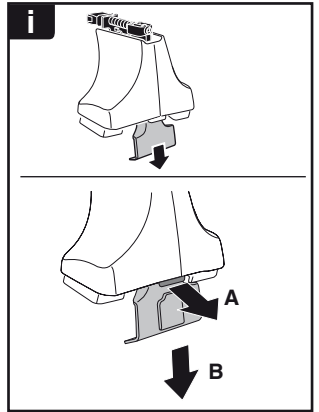
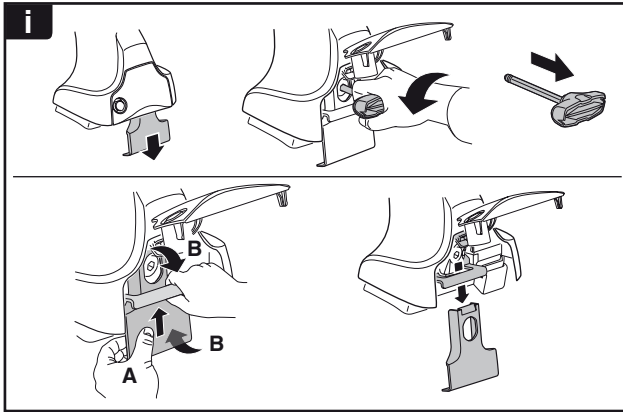

THULE
SWEDEN
**ONE
KEY
SYSTEM**

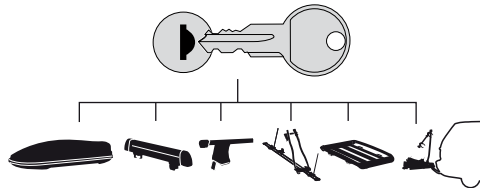

- 544 (x4)
- 596 (x6)
- 588 (x8)
- NA 510 (x10)
- EUR 452 (x12)
- ASIA



WW ▶ Thule Sweden AB, Box 69, 330 33 Hillerstorp, SWEDEN
NA ▶ Thule Inc., 42 Silvermine Road, Seymour, Connecticut 06483, USA

info@thule.com
customer.service@thule.com

www.thule.com